

MXL 025

PITCH 0,80" (2,032 mm)
FOR BELT WIDTH 1/4" (6,35 mm)

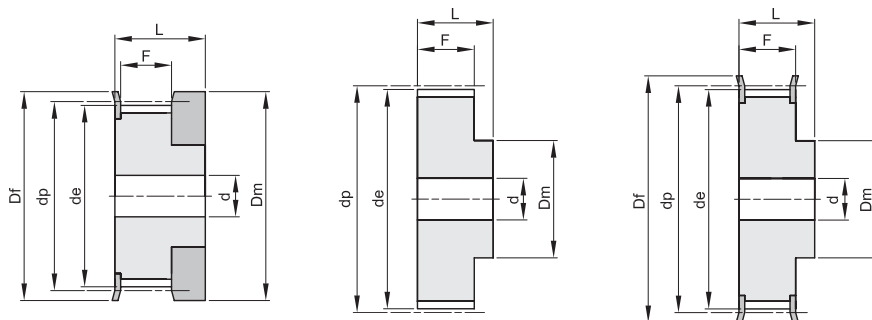

Материал Алуминий / Material Aluminum UNI 9006 -T6

1F

2

2F

| code | type | material | teeth | dp | de | Df | Dm | F | L | d | n° flange | Kg. |
|------------|------|----------|-------|-------|-------|----|----|-----|----|---|-----------|------|
| 16 MXL 025 | 1F | Al | 16 | 10,35 | 9,84 | 15 | 15 | 8,5 | 16 | | 101 | 0,01 |
| 18 MXL 025 | 1F | Al | 18 | 11,64 | 11,13 | 16 | 16 | 8,5 | 16 | | 102 | 0,01 |
| 20 MXL 025 | 1F | Al | 20 | 12,94 | 12,43 | 16 | 16 | 8,5 | 16 | | 102 | 0,01 |
| 22 MXL 025 | 2F | Al | 22 | 14,23 | 13,72 | 18 | 10 | 11 | 16 | 3 | 104 | 0,01 |
| 24 MXL 025 | 2F | Al | 24 | 15,52 | 15,02 | 18 | 10 | 11 | 16 | 3 | 104 | 0,01 |
| 28 MXL 025 | 2F | Al | 28 | 18,11 | 17,60 | 23 | 11 | 11 | 16 | 3 | 107 | 0,01 |
| 30 MXL 025 | 2F | Al | 30 | 19,40 | 18,90 | 23 | 12 | 11 | 16 | 4 | 107 | 0,02 |
| 32 MXL 025 | 2F | Al | 32 | 20,70 | 20,19 | 25 | 14 | 11 | 16 | 4 | 108 | 0,02 |
| 36 MXL 025 | 2F | Al | 36 | 23,29 | 22,78 | 28 | 16 | 11 | 16 | 4 | 109 | 0,02 |
| 40 MXL 025 | 2F | Al | 40 | 25,87 | 25,36 | 32 | 18 | 11 | 16 | 4 | 110 | 0,03 |
| 42 MXL 025 | 2F | Al | 42 | 27,17 | 26,66 | 32 | 18 | 11 | 16 | 5 | 110 | 0,03 |
| 44 MXL 025 | 2F | Al | 44 | 28,46 | 27,95 | 36 | 18 | 11 | 16 | 5 | 111 | 0,03 |
| 48 MXL 025 | 2 | Al | 48 | 31,05 | 30,54 | | 20 | 11 | 16 | 5 | | 0,03 |
| 60 MXL 025 | 2 | Al | 60 | 38,81 | 38,30 | | 24 | 11 | 16 | 5 | | 0,04 |
| 72 MXL 025 | 2 | Al | 72 | 46,57 | 46,06 | | 25 | 11 | 16 | 6 | | 0,05 |

XL 037

PITCH 1/5" (5,08 mm)

FOR BELT WIDTH 3/8" (9,52 mm)

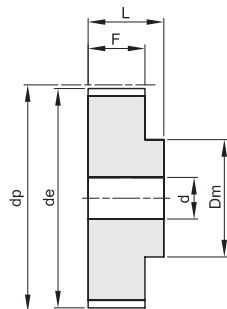

2

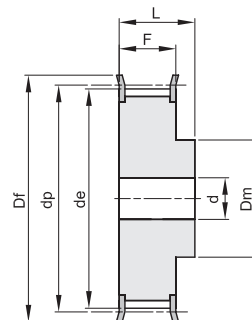

2F

Материал Алуминий / Material Aluminum UNI 9006 -T6

| code | type | material | teeth | dp | de | Df | Dm | F | L | d | n° flange | Kg. |
|-----------|------|----------|-------|--------|--------|----|----|------|----|----|-----------|------|
| 10 XL 037 | 2F | Al | 10 | 16,17 | 15,66 | 23 | 10 | 14,3 | 20 | | 201 | 0,01 |
| 11 XL 037 | 2F | Al | 11 | 17,79 | 17,28 | 23 | 10 | 14,3 | 20 | | 201 | 0,01 |
| 12 XL 037 | 2F | Al | 12 | 19,40 | 18,90 | 25 | 10 | 14,3 | 20 | | 203 | 0,01 |
| 13 XL 037 | 2F | Al | 13 | 21,02 | 20,51 | 25 | 10 | 14,3 | 20 | | 203 | 0,01 |
| 14 XL 037 | 2F | Al | 14 | 22,64 | 22,13 | 28 | 16 | 14,3 | 20 | | 204 | 0,02 |
| 15 XL 037 | 2F | Al | 15 | 24,25 | 23,75 | 28 | 16 | 14,3 | 20 | | 204 | 0,02 |
| 16 XL 037 | 2F | Al | 16 | 25,87 | 25,36 | 32 | 16 | 14,3 | 20 | | 205 | 0,03 |
| 17 XL 037 | 2F | Al | 17 | 27,49 | 26,98 | 32 | 20 | 14,3 | 20 | | 205 | 0,03 |
| 18 XL 037 | 2F | Al | 18 | 29,11 | 28,60 | 36 | 20 | 14,3 | 20 | | 206 | 0,04 |
| 19 XL 037 | 2F | Al | 19 | 30,72 | 30,21 | 36 | 20 | 14,3 | 22 | | 206 | 0,04 |
| 20 XL 037 | 2F | Al | 20 | 32,34 | 31,83 | 38 | 25 | 14,3 | 22 | | 207 | 0,05 |
| 21 XL 037 | 2F | Al | 21 | 33,96 | 33,45 | 38 | 25 | 14,3 | 22 | | 207 | 0,05 |
| 22 XL 037 | 2F | Al | 22 | 35,57 | 35,07 | 42 | 25 | 14,3 | 22 | | 208 | 0,06 |
| 24 XL 037 | 2F | Al | 24 | 38,81 | 38,30 | 44 | 30 | 14,3 | 22 | | 209 | 0,06 |
| 26 XL 037 | 2F | Al | 26 | 42,04 | 41,53 | 48 | 30 | 14,3 | 22 | 8 | 210 | 0,09 |
| 27 XL 037 | 2F | Al | 27 | 43,66 | 43,15 | 48 | 34 | 14,3 | 22 | 8 | 210 | 0,09 |
| 28 XL 037 | 2F | Al | 28 | 45,28 | 44,77 | 51 | 34 | 14,3 | 22 | 8 | 211 | 0,10 |
| 30 XL 037 | 2F | Al | 30 | 48,51 | 48,00 | 54 | 38 | 14,3 | 22 | 8 | 212 | 0,12 |
| 32 XL 037 | 2F | Al | 32 | 51,74 | 51,24 | 57 | 38 | 14,3 | 25 | 8 | 213 | 0,12 |
| 34 XL 037 | 2F | Al | 34 | 54,98 | 54,47 | 60 | 38 | 14,3 | 25 | 8 | 214 | 0,13 |
| 35 XL 037 | 2F | Al | 35 | 56,60 | 56,09 | 63 | 38 | 14,3 | 25 | 8 | 215 | 0,14 |
| 36 XL 037 | 2 | Al | 36 | 58,21 | 57,70 | | 45 | 14,3 | 25 | 8 | | 0,14 |
| 38 XL 037 | 2 | Al | 38 | 61,45 | 60,94 | | 45 | 14,3 | 25 | 8 | | 0,15 |
| 40 XL 037 | 2 | Al | 40 | 64,68 | 64,17 | | 45 | 14,3 | 25 | 8 | | 0,16 |
| 42 XL 037 | 2 | Al | 42 | 67,91 | 67,41 | | 45 | 14,3 | 25 | 8 | | 0,18 |
| 44 XL 037 | 2 | Al | 44 | 71,15 | 70,64 | | 45 | 14,3 | 25 | 8 | | 0,19 |
| 48 XL 037 | 2 | Al | 48 | 77,62 | 77,11 | | 45 | 14,3 | 25 | 10 | | 0,19 |
| 52 XL 037 | 2 | Al | 52 | 84,08 | 83,57 | | 45 | 14,3 | 25 | 10 | | 0,19 |
| 60 XL 037 | 2 | Al | 60 | 97,02 | 96,51 | | 45 | 14,3 | 25 | 10 | | 0,22 |
| 72 XL 037 | 2 | Al | 72 | 116,42 | 115,92 | | 45 | 14,3 | 25 | 10 | | 0,44 |

L 050

PITCH 3/8" (9,525 mm)
FOR BELT WIDTH 1/2" (12,7 mm)

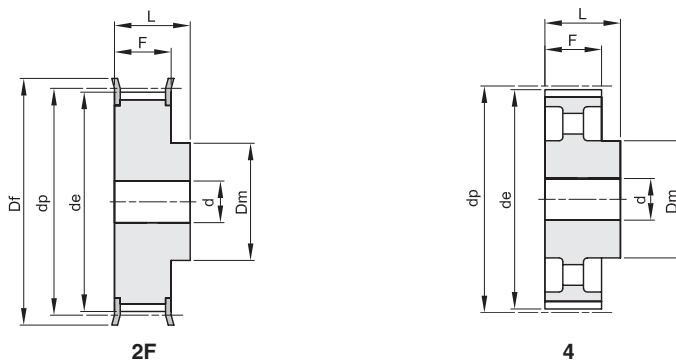

Материал Стомана (St) / Material Steel (St)

Материал Чугун (GG) / Material Cast Iron (GG)

| code | type | material | teeth | dp | de | Df | Dm | F | L | d | n° flange | Kg. |
|----------|------|----------|-------|--------|--------|-----|----|------|----|----|-----------|------|
| 10 L 050 | 2F | St | 10 | 30,32 | 29,56 | 36 | 20 | 19,0 | 28 | 8 | 300 | 0,11 |
| 11 L 050 | 2F | St | 11 | 33,35 | 32,59 | 38 | 24 | 19,0 | 30 | 8 | 301 | 0,14 |
| 12 L 050 | 2F | St | 12 | 36,38 | 35,62 | 42 | 24 | 19,0 | 30 | 8 | 302 | 0,17 |
| 13 L 050 | 2F | St | 13 | 39,41 | 38,65 | 44 | 28 | 19,0 | 30 | 8 | 303 | 0,21 |
| 14 L 050 | 2F | St | 14 | 42,44 | 41,68 | 48 | 28 | 19,0 | 30 | 8 | 304 | 0,24 |
| 15 L 050 | 2F | St | 15 | 45,48 | 44,72 | 51 | 34 | 19,0 | 30 | 8 | 305 | 0,29 |
| 16 L 050 | 2F | St | 16 | 48,51 | 47,75 | 54 | 36 | 19,0 | 32 | 8 | 306 | 0,33 |
| 17 L 050 | 2F | St | 17 | 51,54 | 50,78 | 57 | 36 | 19,0 | 32 | 10 | 307 | 0,38 |
| 18 L 050 | 2F | St | 18 | 54,57 | 53,81 | 60 | 40 | 19,0 | 32 | 10 | 308 | 0,44 |
| 19 L 050 | 2F | St | 19 | 57,61 | 56,84 | 63 | 40 | 19,0 | 32 | 10 | 309 | 0,47 |
| 20 L 050 | 2F | St | 20 | 60,64 | 59,88 | 66 | 40 | 19,0 | 32 | 10 | 310 | 0,51 |
| 21 L 050 | 2F | St | 21 | 63,67 | 62,91 | 71 | 45 | 19,0 | 32 | 10 | 311 | 0,60 |
| 22 L 050 | 2F | St | 22 | 66,70 | 65,94 | 75 | 45 | 19,0 | 32 | 10 | 312 | 0,64 |
| 23 L 050 | 2F | St | 23 | 69,73 | 68,97 | 79 | 55 | 19,0 | 32 | 10 | 313 | 0,78 |
| 24 L 050 | 2F | St | 24 | 72,77 | 72,00 | 79 | 55 | 19,0 | 32 | 10 | 313 | 0,81 |
| 25 L 050 | 2F | St | 25 | 75,80 | 75,04 | 83 | 58 | 19,0 | 32 | 10 | 314 | 0,89 |
| 26 L 050 | 2F | St | 26 | 78,83 | 78,07 | 87 | 58 | 19,0 | 32 | 12 | 315 | 0,94 |
| 27 L 050 | 2F | St | 27 | 81,86 | 81,10 | 87 | 58 | 19,0 | 32 | 12 | 315 | 0,99 |
| 28 L 050 | 2F | St | 28 | 84,89 | 84,13 | 91 | 58 | 19,0 | 32 | 12 | 316 | 1,04 |
| 30 L 050 | 2F | St | 30 | 90,96 | 90,20 | 97 | 70 | 19,0 | 32 | 12 | 318 | 1,17 |
| 32 L 050 | 2F | St | 32 | 97,03 | 96,26 | 103 | 70 | 19,0 | 32 | 12 | 320 | 1,41 |
| 33 L 050 | 2F | St | 33 | 100,05 | 99,29 | 106 | 70 | 19,0 | 32 | 12 | 321 | 1,49 |
| 34 L 050 | 2F | St | 34 | 103,08 | 102,32 | 111 | 70 | 19,0 | 32 | 12 | 322 | 1,57 |
| 35 L 050 | 2F | St | 35 | 106,12 | 105,35 | 111 | 70 | 19,0 | 32 | 12 | 322 | 1,62 |
| 36 L 050 | 2F | St | 36 | 109,15 | 108,39 | 115 | 70 | 19,0 | 32 | 12 | 323 | 1,70 |
| 40 L 050 | 2F | St | 40 | 121,29 | 120,51 | 127 | 70 | 19,0 | 32 | 12 | 327 | 2,03 |
| 42 L 050 | 2F | St | 42 | 127,34 | 126,58 | 135 | 70 | 19,0 | 32 | 12 | 328 | 2,21 |
| 44 L 050 | 2F | St | 44 | 133,40 | 132,64 | 140 | 70 | 19,0 | 32 | 12 | 330 | 2,38 |
| 45 L 050 | 2F | St | 45 | 136,44 | 135,67 | 143 | 70 | 19,0 | 32 | 12 | 331 | 2,48 |
| 48 L 050 | 2F | St | 48 | 145,53 | 144,77 | 152 | 70 | 19,0 | 32 | 12 | 334 | 2,78 |
| 50 L 050 | 4 | GG | 50 | 151,60 | 150,83 | | 70 | 19,0 | 32 | 14 | | 1,74 |
| 52 L 050 | 4 | GG | 52 | 157,66 | 156,90 | | 70 | 19,0 | 32 | 14 | | 1,80 |
| 56 L 050 | 4 | GG | 56 | 169,79 | 169,02 | | 70 | 19,0 | 32 | 14 | | 1,87 |
| 57 L 050 | 4 | GG | 57 | 172,82 | 172,06 | | 70 | 19,0 | 32 | 14 | | 1,88 |
| 60 L 050 | 4 | GG | 60 | 181,91 | 181,15 | | 75 | 19,0 | 42 | 14 | | 2,41 |
| 72 L 050 | 4 | GG | 72 | 218,29 | 217,53 | | 75 | 19,0 | 42 | 14 | | 2,82 |
| 84 L 050 | 4 | GG | 84 | 254,68 | 253,92 | | 75 | 19,0 | 42 | 14 | | 3,08 |
| 96 L 050 | 4 | GG | 96 | 291,06 | 290,30 | | 75 | 19,0 | 42 | 14 | | 3,42 |

L 075

PITCH 3/8" (9,525 mm)
FOR BELT WIDTH 3/4" (19,05 mm)

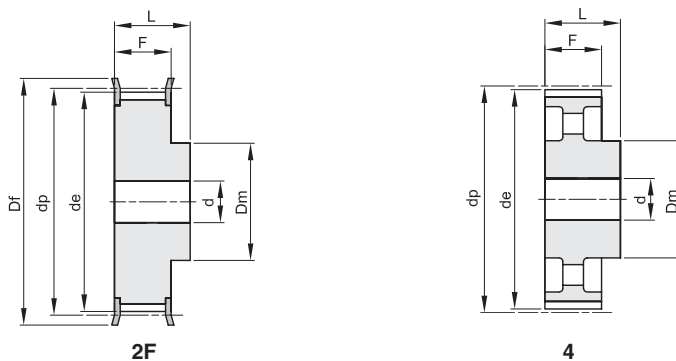

Материал Стомана (St) / Material Steel (St)

Материал Чугун (GG) / Material Cast Iron (GG)

| code | type | material | teeth | dp | de | Df | Dm | F | L | d | n° flange | Kg. |
|----------|------|----------|-------|--------|--------|-----|----|------|----|----|-----------|------|
| 10 L 075 | 2F | St | 10 | 30,32 | 29,56 | 36 | 20 | 25,4 | 38 | 8 | 300 | 0,14 |
| 11 L 075 | 2F | St | 11 | 33,35 | 32,59 | 38 | 24 | 25,4 | 38 | 8 | 301 | 0,18 |
| 12 L 075 | 2F | St | 12 | 36,38 | 35,62 | 42 | 24 | 25,4 | 38 | 8 | 302 | 0,22 |
| 13 L 075 | 2F | St | 13 | 39,41 | 38,65 | 44 | 28 | 25,4 | 38 | 8 | 303 | 0,26 |
| 14 L 075 | 2F | St | 14 | 42,44 | 41,68 | 48 | 28 | 25,4 | 38 | 8 | 304 | 0,30 |
| 15 L 075 | 2F | St | 15 | 45,48 | 44,72 | 51 | 34 | 25,4 | 38 | 8 | 305 | 0,37 |
| 16 L 075 | 2F | St | 16 | 48,51 | 47,75 | 54 | 36 | 25,4 | 38 | 8 | 306 | 0,43 |
| 17 L 075 | 2F | St | 17 | 51,54 | 50,78 | 57 | 36 | 25,4 | 38 | 10 | 307 | 0,46 |
| 18 L 075 | 2F | St | 18 | 54,57 | 53,81 | 60 | 40 | 25,4 | 38 | 10 | 308 | 0,54 |
| 19 L 075 | 2F | St | 19 | 57,61 | 56,84 | 63 | 40 | 25,4 | 38 | 10 | 309 | 0,58 |
| 20 L 075 | 2F | St | 20 | 60,64 | 59,88 | 66 | 40 | 25,4 | 38 | 10 | 310 | 0,64 |
| 21 L 075 | 2F | St | 21 | 63,67 | 62,91 | 71 | 45 | 25,4 | 38 | 10 | 311 | 0,71 |
| 22 L 075 | 2F | St | 22 | 66,70 | 65,94 | 75 | 45 | 25,4 | 38 | 10 | 312 | 0,79 |
| 23 L 075 | 2F | St | 23 | 69,73 | 68,97 | 79 | 55 | 25,4 | 38 | 10 | 313 | 0,94 |
| 24 L 075 | 2F | St | 24 | 72,77 | 72,00 | 79 | 55 | 25,4 | 38 | 10 | 313 | 1,00 |
| 25 L 075 | 2F | St | 25 | 75,80 | 75,04 | 83 | 58 | 25,4 | 38 | 10 | 314 | 1,10 |
| 26 L 075 | 2F | St | 26 | 78,83 | 78,07 | 87 | 58 | 25,4 | 38 | 12 | 315 | 1,16 |
| 27 L 075 | 2F | St | 27 | 81,86 | 81,10 | 87 | 58 | 25,4 | 38 | 12 | 315 | 1,22 |
| 28 L 075 | 2F | St | 28 | 84,89 | 84,13 | 91 | 58 | 25,4 | 38 | 12 | 316 | 1,30 |
| 30 L 075 | 2F | St | 30 | 90,96 | 90,20 | 97 | 70 | 25,4 | 38 | 12 | 318 | 1,47 |
| 32 L 075 | 2F | St | 32 | 97,03 | 96,26 | 103 | 70 | 25,4 | 38 | 12 | 320 | 1,75 |
| 33 L 075 | 2F | St | 33 | 100,05 | 99,29 | 106 | 70 | 25,4 | 38 | 12 | 321 | 1,85 |
| 34 L 075 | 2F | St | 34 | 103,08 | 102,32 | 111 | 70 | 25,4 | 38 | 12 | 322 | 1,93 |
| 35 L 075 | 2F | St | 35 | 106,12 | 105,35 | 111 | 70 | 25,4 | 38 | 12 | 322 | 2,03 |
| 36 L 075 | 2F | St | 36 | 109,15 | 108,39 | 115 | 70 | 25,4 | 38 | 12 | 323 | 2,14 |
| 40 L 075 | 2F | St | 40 | 121,29 | 120,51 | 127 | 70 | 25,4 | 38 | 12 | 327 | 2,56 |
| 42 L 075 | 2F | St | 42 | 127,34 | 126,58 | 135 | 70 | 25,4 | 38 | 12 | 328 | 2,81 |
| 44 L 075 | 2F | St | 44 | 133,40 | 132,64 | 140 | 70 | 25,4 | 38 | 12 | 330 | 3,02 |
| 45 L 075 | 2F | St | 45 | 136,44 | 135,67 | 143 | 70 | 25,4 | 38 | 12 | 331 | 3,16 |
| 48 L 075 | 2F | St | 48 | 145,53 | 144,77 | 152 | 70 | 25,4 | 38 | 12 | 334 | 3,57 |
| 50 L 075 | 4 | GG | 50 | 151,60 | 150,83 | | 70 | 25,4 | 38 | 14 | | 2,10 |
| 52 L 075 | 4 | GG | 52 | 157,66 | 156,90 | | 70 | 25,4 | 38 | 14 | | 2,13 |
| 56 L 075 | 4 | GG | 56 | 169,79 | 169,02 | | 70 | 25,4 | 38 | 14 | | 2,27 |
| 57 L 075 | 4 | GG | 57 | 172,82 | 172,06 | | 70 | 25,4 | 38 | 14 | | 2,28 |
| 60 L 075 | 4 | GG | 60 | 181,91 | 181,15 | | 75 | 25,4 | 45 | 14 | | 2,70 |
| 72 L 075 | 4 | GG | 72 | 218,29 | 217,53 | | 75 | 25,4 | 45 | 14 | | 3,19 |
| 84 L 075 | 4 | GG | 84 | 254,68 | 253,92 | | 75 | 25,4 | 45 | 14 | | 3,64 |
| 96 L 075 | 4 | GG | 96 | 291,06 | 290,30 | | 75 | 25,4 | 45 | 14 | | 4,04 |

L 100

PITCH 3/8" (9,525 mm)
FOR BELT WIDTH 1" (25,4 mm)

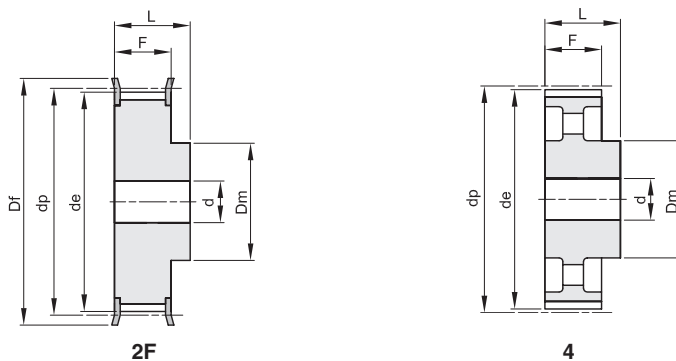

Материал Стомана (St) / Material Steel (St)

Материал Чугун (GG) / Material Cast Iron (GG)

| code | type | material | teeth | dp | de | Df | Dm | F | L | d | n° flange | Kg. |
|----------|------|----------|-------|--------|--------|-----|----|------|----|----|-----------|------|
| 10 L 100 | 2F | St | 10 | 30,32 | 29,56 | 36 | 20 | 31,8 | 45 | 8 | 300 | 0,17 |
| 11 L 100 | 2F | St | 11 | 33,35 | 32,59 | 38 | 24 | 31,8 | 45 | 8 | 301 | 0,22 |
| 12 L 100 | 2F | St | 12 | 36,38 | 35,62 | 42 | 24 | 31,8 | 45 | 8 | 302 | 0,26 |
| 13 L 100 | 2F | St | 13 | 39,41 | 38,65 | 44 | 28 | 31,8 | 45 | 8 | 303 | 0,32 |
| 14 L 100 | 2F | St | 14 | 42,44 | 41,68 | 48 | 28 | 31,8 | 45 | 10 | 304 | 0,35 |
| 15 L 100 | 2F | St | 15 | 45,48 | 44,72 | 51 | 34 | 31,8 | 45 | 10 | 305 | 0,43 |
| 16 L 100 | 2F | St | 16 | 48,51 | 47,75 | 54 | 36 | 31,8 | 45 | 10 | 306 | 0,50 |
| 17 L 100 | 2F | St | 17 | 51,54 | 50,78 | 57 | 36 | 31,8 | 45 | 10 | 307 | 0,56 |
| 18 L 100 | 2F | St | 18 | 54,57 | 53,81 | 60 | 40 | 31,8 | 45 | 10 | 308 | 0,64 |
| 19 L 100 | 2F | St | 19 | 57,61 | 56,84 | 63 | 40 | 31,8 | 45 | 10 | 309 | 0,70 |
| 20 L 100 | 2F | St | 20 | 60,64 | 59,88 | 66 | 40 | 31,8 | 45 | 10 | 310 | 0,77 |
| 21 L 100 | 2F | St | 21 | 63,67 | 62,91 | 71 | 45 | 31,8 | 45 | 10 | 311 | 0,88 |
| 22 L 100 | 2F | St | 22 | 66,70 | 65,94 | 75 | 45 | 31,8 | 45 | 12 | 312 | 0,95 |
| 23 L 100 | 2F | St | 23 | 69,73 | 68,97 | 79 | 55 | 31,8 | 45 | 12 | 313 | 1,11 |
| 24 L 100 | 2F | St | 24 | 72,77 | 72,00 | 79 | 55 | 31,8 | 45 | 12 | 313 | 1,18 |
| 25 L 100 | 2F | St | 25 | 75,80 | 75,04 | 83 | 58 | 31,8 | 45 | 12 | 314 | 1,30 |
| 26 L 100 | 2F | St | 26 | 78,83 | 78,07 | 87 | 58 | 31,8 | 45 | 12 | 315 | 1,40 |
| 27 L 100 | 2F | St | 27 | 81,86 | 81,10 | 87 | 58 | 31,8 | 45 | 12 | 315 | 1,47 |
| 28 L 100 | 2F | St | 28 | 84,89 | 84,13 | 91 | 58 | 31,8 | 45 | 12 | 316 | 1,58 |
| 30 L 100 | 2F | St | 30 | 90,96 | 90,20 | 97 | 70 | 31,8 | 45 | 12 | 318 | 1,78 |
| 32 L 100 | 2F | St | 32 | 97,03 | 96,26 | 103 | 70 | 31,8 | 45 | 12 | 320 | 2,11 |
| 33 L 100 | 2F | St | 33 | 100,05 | 99,29 | 106 | 70 | 31,8 | 45 | 12 | 321 | 2,23 |
| 34 L 100 | 2F | St | 34 | 103,08 | 102,32 | 111 | 70 | 31,8 | 45 | 12 | 322 | 2,39 |
| 35 L 100 | 2F | St | 35 | 106,12 | 105,35 | 111 | 70 | 31,8 | 45 | 12 | 322 | 2,45 |
| 36 L 100 | 2F | St | 36 | 109,15 | 108,39 | 115 | 70 | 31,8 | 45 | 12 | 323 | 2,59 |
| 40 L 100 | 2F | St | 40 | 121,29 | 120,51 | 127 | 70 | 31,8 | 45 | 12 | 327 | 3,13 |
| 42 L 100 | 2F | St | 42 | 127,34 | 126,58 | 135 | 70 | 31,8 | 45 | 12 | 328 | 3,43 |
| 44 L 100 | 2F | St | 44 | 133,40 | 132,64 | 140 | 70 | 31,8 | 45 | 12 | 330 | 3,72 |
| 45 L 100 | 2F | St | 45 | 136,44 | 135,67 | 143 | 70 | 31,8 | 45 | 12 | 331 | 3,89 |
| 48 L 100 | 2F | St | 48 | 145,53 | 144,77 | 152 | 70 | 31,8 | 45 | 12 | 334 | 4,38 |
| 50 L 100 | 4 | GG | 50 | 151,60 | 150,83 | | 70 | 31,8 | 45 | 14 | | 2,41 |
| 52 L 100 | 4 | GG | 52 | 157,66 | 156,90 | | 70 | 31,8 | 45 | 14 | | 2,55 |
| 56 L 100 | 4 | GG | 56 | 169,79 | 169,02 | | 70 | 31,8 | 45 | 14 | | 2,65 |
| 57 L 100 | 4 | GG | 57 | 172,82 | 172,06 | | 70 | 31,8 | 45 | 14 | | 2,71 |
| 60 L 100 | 4 | GG | 60 | 181,91 | 181,15 | | 75 | 31,8 | 45 | 14 | | 3,11 |
| 72 L 100 | 4 | GG | 72 | 218,29 | 217,53 | | 75 | 31,8 | 45 | 14 | | 3,65 |
| 84 L 100 | 4 | GG | 84 | 254,68 | 253,92 | | 75 | 31,8 | 45 | 14 | | 4,12 |
| 96 L 100 | 4 | GG | 96 | 291,06 | 290,30 | | 75 | 31,8 | 45 | 14 | | 4,60 |

H 075

PITCH 1/2" (12,7 mm)
FOR BELT WIDTH 3/4" (19,05 mm)

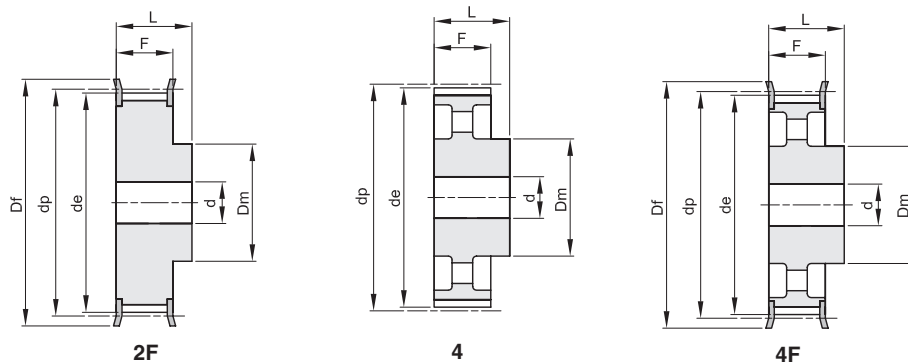

Материал Стомана (St) / Material Steel (St)

Материал Чугун (GG) / Material Cast Iron (GG)

| code | type | material | teeth | dp | de | Df | Dm | F | L | d | n° flange | Kg. |
|----------|------|----------|-------|--------|--------|-----|----|------|----|----|-----------|------|
| 14 H 075 | 2F | St | 14 | 56,59 | 55,22 | 63 | 40 | 26,4 | 40 | 10 | 309 | 0,58 |
| 15 H 075 | 2F | St | 15 | 60,64 | 59,27 | 66 | 45 | 26,4 | 40 | 10 | 310 | 0,69 |
| 16 H 075 | 2F | St | 16 | 64,68 | 63,31 | 71 | 45 | 26,4 | 40 | 10 | 311 | 0,77 |
| 17 H 075 | 2F | St | 17 | 68,72 | 67,35 | 75 | 45 | 26,4 | 40 | 12 | 312 | 0,84 |
| 18 H 075 | 2F | St | 18 | 72,77 | 71,39 | 79 | 55 | 26,4 | 40 | 12 | 313 | 1,01 |
| 19 H 075 | 2F | St | 19 | 76,81 | 75,44 | 83 | 60 | 26,4 | 40 | 12 | 314 | 1,15 |
| 20 H 075 | 2F | St | 20 | 80,85 | 79,48 | 87 | 62 | 26,4 | 40 | 12 | 315 | 1,27 |
| 21 H 075 | 2F | St | 21 | 84,89 | 83,52 | 91 | 65 | 26,4 | 40 | 12 | 316 | 1,41 |
| 22 H 075 | 2F | St | 22 | 88,94 | 87,56 | 93 | 68 | 26,4 | 40 | 12 | 317 | 1,55 |
| 23 H 075 | 2F | St | 23 | 92,98 | 91,61 | 97 | 72 | 26,4 | 40 | 12 | 318 | 1,71 |
| 24 H 075 | 2F | St | 24 | 97,03 | 95,65 | 103 | 72 | 26,4 | 40 | 12 | 320 | 1,83 |
| 25 H 075 | 2F | St | 25 | 101,06 | 99,69 | 106 | 72 | 26,4 | 40 | 12 | 321 | 1,96 |
| 26 H 075 | 2F | St | 26 | 105,11 | 103,73 | 111 | 80 | 26,4 | 40 | 12 | 322 | 2,19 |
| 27 H 075 | 2F | St | 27 | 109,15 | 107,78 | 115 | 80 | 26,4 | 40 | 12 | 323 | 2,32 |
| 28 H 075 | 2F | St | 28 | 113,19 | 111,82 | 119 | 80 | 26,4 | 40 | 12 | 325 | 2,47 |
| 30 H 075 | 2F | St | 30 | 121,29 | 119,90 | 127 | 80 | 26,4 | 40 | 14 | 327 | 2,76 |
| 32 H 075 | 2F | St | 32 | 129,36 | 127,99 | 135 | 80 | 26,4 | 40 | 14 | 328 | 3,08 |
| 33 H 075 | 2F | St | 33 | 133,40 | 132,03 | 140 | 80 | 26,4 | 40 | 14 | 330 | 3,25 |
| 34 H 075 | 2F | St | 34 | 137,45 | 136,07 | 143 | 80 | 26,4 | 40 | 14 | 331 | 3,42 |
| 35 H 075 | 2F | St | 35 | 141,49 | 140,12 | 148 | 80 | 26,4 | 40 | 14 | 333 | 3,61 |
| 36 H 075 | 2F | St | 36 | 145,53 | 144,16 | 152 | 80 | 26,4 | 40 | 14 | 334 | 3,79 |
| 38 H 075 | 2F | St | 38 | 153,62 | 152,24 | 158 | 80 | 26,4 | 40 | 14 | 335 | 4,16 |
| 40 H 075 | 2F | St | 40 | 161,70 | 160,33 | 168 | 80 | 26,4 | 40 | 14 | 338 | 4,58 |
| 44 H 075 | 4F | GG | 44 | 177,87 | 176,50 | 184 | 80 | 26,4 | 40 | 18 | 339 | 2,57 |
| 48 H 075 | 4F | GG | 48 | 194,04 | 192,67 | 200 | 90 | 26,4 | 45 | 18 | 342 | 3,56 |
| 50 H 075 | 4 | GG | 50 | 202,13 | 200,75 | | 90 | 26,4 | 45 | 18 | | 3,74 |

H 100

PITCH 1/2" (12,7 mm)

PFOR BELT WIDTH 1" (25,4 mm)

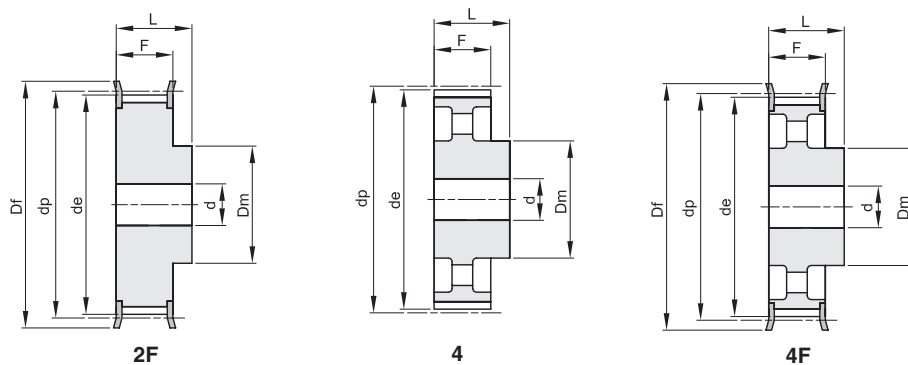

Материал Стомана (St) / Material Steel (St)

Материал Чугун (GG) / Material Cast Iron (GG)

| code | type | material | teeth | dp | de | Df | Dm | F | L | d | n° flange | Kg. |
|-----------|------|----------|-------|--------|--------|-----|-----|------|----|----|-----------|-------|
| 14 H 100 | 2F | St | 14 | 56,59 | 55,22 | 63 | 40 | 31,8 | 45 | 12 | 309 | 0,65 |
| 15 H 100 | 2F | St | 15 | 60,64 | 59,27 | 66 | 45 | 31,8 | 45 | 12 | 310 | 0,77 |
| 16 H 100 | 2F | St | 16 | 64,68 | 63,31 | 71 | 45 | 31,8 | 45 | 12 | 311 | 0,87 |
| 17 H 100 | 2F | St | 17 | 68,72 | 67,35 | 75 | 45 | 31,8 | 45 | 12 | 312 | 0,97 |
| 18 H 100 | 2F | St | 18 | 72,77 | 71,39 | 79 | 55 | 31,8 | 45 | 12 | 313 | 1,16 |
| 19 H 100 | 2F | St | 19 | 76,81 | 75,44 | 83 | 60 | 31,8 | 45 | 14 | 314 | 1,30 |
| 20 H 100 | 2F | St | 20 | 80,85 | 79,48 | 87 | 62 | 31,8 | 45 | 14 | 315 | 1,44 |
| 21 H 100 | 2F | St | 21 | 84,89 | 83,52 | 91 | 65 | 31,8 | 45 | 14 | 316 | 1,60 |
| 22 H 100 | 2F | St | 22 | 88,94 | 87,56 | 93 | 68 | 31,8 | 45 | 14 | 317 | 1,76 |
| 23 H 100 | 2F | St | 23 | 92,98 | 91,61 | 97 | 72 | 31,8 | 45 | 14 | 318 | 1,94 |
| 24 H 100 | 2F | St | 24 | 97,03 | 95,65 | 103 | 72 | 31,8 | 45 | 14 | 320 | 2,09 |
| 25 H 100 | 2F | St | 25 | 101,06 | 99,69 | 106 | 72 | 31,8 | 45 | 14 | 321 | 2,24 |
| 26 H 100 | 2F | St | 26 | 105,11 | 103,73 | 111 | 80 | 31,8 | 45 | 14 | 322 | 2,49 |
| 27 H 100 | 2F | St | 27 | 109,15 | 107,78 | 115 | 80 | 31,8 | 45 | 14 | 323 | 2,66 |
| 28 H 100 | 2F | St | 28 | 113,19 | 111,82 | 119 | 80 | 31,8 | 45 | 14 | 325 | 2,83 |
| 29 H 100 | 2F | St | 29 | 117,23 | 115,86 | 123 | 80 | 31,8 | 45 | 14 | 326 | 3,01 |
| 30 H 100 | 2F | St | 30 | 121,29 | 119,90 | 127 | 80 | 31,8 | 45 | 14 | 327 | 3,19 |
| 32 H 100 | 2F | St | 32 | 129,36 | 127,99 | 135 | 80 | 31,8 | 45 | 14 | 328 | 3,57 |
| 33 H 100 | 2F | St | 33 | 133,40 | 132,03 | 140 | 80 | 31,8 | 45 | 14 | 330 | 3,79 |
| 34 H 100 | 2F | St | 34 | 137,45 | 136,07 | 143 | 80 | 31,8 | 45 | 14 | 331 | 3,99 |
| 35 H 100 | 2F | St | 35 | 141,49 | 140,12 | 148 | 80 | 31,8 | 45 | 14 | 333 | 4,20 |
| 36 H 100 | 2F | St | 36 | 145,53 | 144,16 | 152 | 80 | 31,8 | 45 | 14 | 334 | 4,44 |
| 38 H 100 | 2F | St | 38 | 153,62 | 152,24 | 158 | 80 | 31,8 | 45 | 14 | 335 | 4,90 |
| 40 H 100 | 2F | St | 40 | 161,70 | 160,33 | 168 | 80 | 31,8 | 45 | 14 | 338 | 5,39 |
| 44 H 100 | 4F | GG | 44 | 177,87 | 176,50 | 184 | 80 | 31,8 | 50 | 18 | 339 | 3,37 |
| 45 H 100 | 4F | GG | 45 | 181,91 | 180,54 | 192 | 80 | 31,8 | 50 | 18 | 340 | 3,57 |
| 48 H 100 | 4F | GG | 48 | 194,04 | 192,67 | 200 | 90 | 31,8 | 50 | 18 | 342 | 4,10 |
| 50 H 100 | 4 | GG | 50 | 202,13 | 200,75 | | 90 | 31,8 | 50 | 18 | | 4,24 |
| 52 H 100 | 4 | GG | 52 | 210,21 | 208,84 | | 90 | 31,8 | 50 | 18 | | 4,32 |
| 58 H 100 | 4 | GG | 58 | 234,47 | 233,09 | | 90 | 31,8 | 50 | 18 | | 4,61 |
| 60 H 100 | 4 | GG | 60 | 242,55 | 241,18 | | 100 | 31,8 | 50 | 18 | | 5,30 |
| 70 H 100 | 4 | GG | 70 | 282,98 | 281,61 | | 100 | 31,8 | 55 | 18 | | 6,13 |
| 72 H 100 | 4 | GG | 72 | 291,06 | 289,69 | | 120 | 31,8 | 55 | 18 | | 7,47 |
| 84 H 100 | 4 | GG | 84 | 339,57 | 338,20 | | 120 | 31,8 | 55 | 18 | | 8,52 |
| 96 H 100 | 4 | GG | 96 | 388,08 | 386,71 | | 120 | 31,8 | 60 | 18 | | 10,25 |
| 120 H 100 | 4 | GG | 120 | 485,10 | 483,73 | | 120 | 31,8 | 60 | 18 | | 13,09 |

H 150

PITCH 1/2" (12,7 mm)
FOR BELT WIDTH 1 1/2 (38,1 mm)

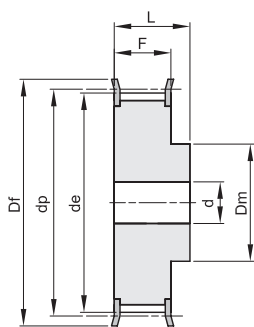

2F

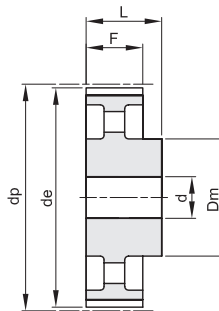

4

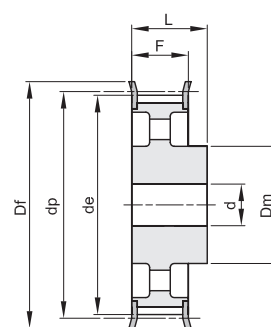

4F

Материал Стомана (St) / Material Steel (St)

Материал Чугун (GG) / Material Cast Iron (GG)

| code | type | material | teeth | dp | de | Df | Dm | F | L | d | n° flange | Kg. |
|-----------|------|----------|-------|--------|--------|-----|-----|------|----|----|-----------|-------|
| 14 H 150 | 2F | St | 14 | 56,59 | 55,22 | 63 | 40 | 46,0 | 58 | 18 | 309 | 0,81 |
| 15 H 150 | 2F | St | 15 | 60,64 | 59,27 | 66 | 45 | 46,0 | 58 | 18 | 310 | 0,97 |
| 16 H 150 | 2F | St | 16 | 64,68 | 63,31 | 71 | 45 | 46,0 | 58 | 18 | 311 | 1,11 |
| 17 H 150 | 2F | St | 17 | 68,72 | 67,35 | 75 | 45 | 46,0 | 58 | 18 | 312 | 1,25 |
| 18 H 150 | 2F | St | 18 | 72,77 | 71,39 | 79 | 55 | 46,0 | 58 | 18 | 313 | 1,48 |
| 19 H 150 | 2F | St | 19 | 76,81 | 75,44 | 83 | 60 | 46,0 | 58 | 18 | 314 | 1,68 |
| 20 H 150 | 2F | St | 20 | 80,85 | 79,48 | 87 | 62 | 46,0 | 58 | 18 | 315 | 1,88 |
| 21 H 150 | 2F | St | 21 | 84,89 | 83,52 | 91 | 65 | 46,0 | 58 | 18 | 316 | 2,08 |
| 22 H 150 | 2F | St | 22 | 88,94 | 87,56 | 93 | 68 | 46,0 | 58 | 18 | 317 | 2,30 |
| 23 H 150 | 2F | St | 23 | 92,98 | 91,61 | 97 | 72 | 46,0 | 58 | 18 | 318 | 2,54 |
| 24 H 150 | 2F | St | 24 | 97,03 | 95,65 | 103 | 72 | 46,0 | 58 | 18 | 320 | 2,75 |
| 25 H 150 | 2F | St | 25 | 101,06 | 99,69 | 106 | 72 | 46,0 | 58 | 18 | 321 | 2,97 |
| 26 H 150 | 2F | St | 26 | 105,11 | 103,73 | 111 | 80 | 46,0 | 58 | 18 | 322 | 3,29 |
| 27 H 150 | 2F | St | 27 | 109,15 | 107,78 | 115 | 80 | 46,0 | 58 | 18 | 323 | 3,52 |
| 28 H 150 | 2F | St | 28 | 113,19 | 111,82 | 119 | 80 | 46,0 | 58 | 18 | 325 | 3,78 |
| 29 H 150 | 2F | St | 29 | 117,23 | 115,86 | 123 | 80 | 46,0 | 58 | 18 | 326 | 4,03 |
| 30 H 150 | 2F | St | 30 | 121,29 | 119,90 | 127 | 80 | 46,0 | 58 | 18 | 327 | 4,29 |
| 32 H 150 | 2F | St | 32 | 129,36 | 127,99 | 135 | 80 | 46,0 | 58 | 18 | 328 | 4,86 |
| 33 H 150 | 2F | St | 33 | 133,40 | 132,03 | 140 | 80 | 46,0 | 58 | 18 | 330 | 5,15 |
| 34 H 150 | 2F | St | 34 | 137,45 | 136,07 | 143 | 80 | 46,0 | 58 | 18 | 331 | 5,46 |
| 35 H 150 | 2F | St | 35 | 141,49 | 140,12 | 148 | 80 | 46,0 | 58 | 18 | 333 | 5,78 |
| 36 H 150 | 2F | St | 36 | 145,53 | 144,16 | 152 | 80 | 46,0 | 58 | 18 | 334 | 6,09 |
| 38 H 150 | 2F | St | 38 | 153,62 | 152,24 | 158 | 80 | 46,0 | 58 | 18 | 335 | 6,74 |
| 40 H 150 | 2F | St | 40 | 161,70 | 160,33 | 168 | 80 | 46,0 | 58 | 18 | 338 | 7,46 |
| 44 H 150 | 4F | GG | 44 | 177,87 | 176,50 | 184 | 80 | 46,0 | 58 | 18 | 339 | 4,29 |
| 45 H 150 | 4F | GG | 45 | 181,91 | 180,54 | 192 | 80 | 46,0 | 58 | 18 | 340 | 4,44 |
| 48 H 150 | 4F | GG | 48 | 194,04 | 192,67 | 200 | 90 | 46,0 | 65 | 18 | 342 | 5,41 |
| 50 H 150 | 4 | GG | 50 | 202,13 | 200,75 | | 90 | 46,0 | 65 | 18 | | 5,59 |
| 52 H 150 | 4 | GG | 52 | 210,21 | 208,84 | | 90 | 46,0 | 65 | 18 | | 5,79 |
| 58 H 150 | 4 | GG | 58 | 234,47 | 233,09 | | 90 | 46,0 | 65 | 18 | | 6,15 |
| 60 H 150 | 4 | GG | 60 | 242,55 | 241,18 | | 100 | 46,0 | 65 | 18 | | 7,08 |
| 70 H 150 | 4 | GG | 70 | 282,98 | 281,61 | | 100 | 46,0 | 65 | 24 | | 7,77 |
| 72 H 150 | 4 | GG | 72 | 291,06 | 289,69 | | 120 | 46,0 | 65 | 24 | | 9,70 |
| 84 H 150 | 4 | GG | 84 | 339,57 | 338,20 | | 120 | 46,0 | 65 | 24 | | 10,99 |
| 96 H 150 | 4 | GG | 96 | 388,08 | 386,71 | | 120 | 46,0 | 65 | 24 | | 12,24 |
| 120 H 150 | 4 | GG | 120 | 485,10 | 483,73 | | 120 | 46,0 | 65 | 24 | | 16,17 |

H 200

PITCH 1/2" (12,7 mm)
FOR BELT WIDTH 2" (50,8 mm)

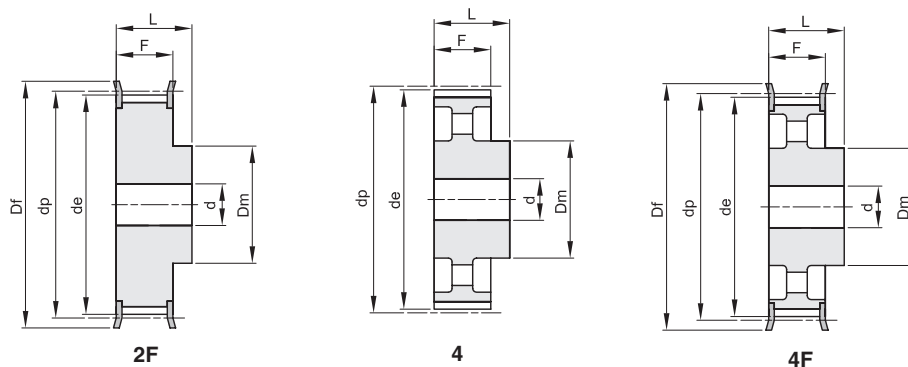

Материал Стомана (St) / Material Steel (St)

Материал Чугун (GG) / Material Cast Iron (GG)

| code | type | material | teeth | dp | de | Df | Dm | F | L | d | n° flange | Kg. |
|-----------|------|----------|-------|--------|--------|-----|-----|------|----|----|-----------|-------|
| 14 H 200 | 2F | St | 14 | 56,59 | 55,22 | 63 | 40 | 58,7 | 70 | 18 | 309 | 1,10 |
| 15 H 200 | 2F | St | 15 | 60,64 | 59,27 | 66 | 45 | 58,7 | 70 | 18 | 310 | 1,33 |
| 16 H 200 | 2F | St | 16 | 64,68 | 63,31 | 71 | 45 | 58,7 | 70 | 18 | 311 | 1,54 |
| 17 H 200 | 2F | St | 17 | 68,72 | 67,35 | 75 | 45 | 58,7 | 70 | 18 | 312 | 1,69 |
| 18 H 200 | 2F | St | 18 | 72,77 | 71,39 | 79 | 55 | 58,7 | 70 | 18 | 313 | 1,95 |
| 19 H 200 | 2F | St | 19 | 76,81 | 75,44 | 83 | 60 | 58,7 | 70 | 18 | 314 | 2,20 |
| 20 H 200 | 2F | St | 20 | 80,85 | 79,48 | 87 | 62 | 58,7 | 70 | 18 | 315 | 2,44 |
| 21 H 200 | 2F | St | 21 | 84,89 | 83,52 | 91 | 65 | 58,7 | 70 | 18 | 316 | 2,70 |
| 22 H 200 | 2F | St | 22 | 88,94 | 87,56 | 93 | 68 | 58,7 | 70 | 18 | 317 | 2,97 |
| 23 H 200 | 2F | St | 23 | 92,98 | 91,61 | 97 | 72 | 58,7 | 70 | 18 | 318 | 3,25 |
| 24 H 200 | 2F | St | 24 | 97,03 | 95,65 | 103 | 72 | 58,7 | 70 | 18 | 320 | 3,56 |
| 25 H 200 | 2F | St | 25 | 101,06 | 99,69 | 106 | 72 | 58,7 | 70 | 18 | 321 | 3,81 |
| 26 H 200 | 2F | St | 26 | 105,11 | 103,73 | 111 | 80 | 58,7 | 70 | 18 | 322 | 4,18 |
| 27 H 200 | 2F | St | 27 | 109,15 | 107,78 | 115 | 80 | 58,7 | 70 | 18 | 323 | 4,49 |
| 28 H 200 | 2F | St | 28 | 113,19 | 111,82 | 119 | 80 | 58,7 | 70 | 18 | 325 | 4,81 |
| 29 H 200 | 2F | St | 29 | 117,23 | 115,86 | 123 | 80 | 58,7 | 70 | 18 | 326 | 5,14 |
| 30 H 200 | 2F | St | 30 | 121,29 | 119,90 | 127 | 80 | 58,7 | 70 | 18 | 327 | 5,47 |
| 32 H 200 | 2F | St | 32 | 129,36 | 127,99 | 135 | 80 | 58,7 | 70 | 18 | 328 | 6,17 |
| 33 H 200 | 2F | St | 33 | 133,40 | 132,03 | 140 | 80 | 58,7 | 70 | 18 | 330 | 6,56 |
| 34 H 200 | 2F | St | 34 | 137,45 | 136,07 | 143 | 80 | 58,7 | 70 | 18 | 331 | 6,94 |
| 35 H 200 | 2F | St | 35 | 141,49 | 140,12 | 148 | 80 | 58,7 | 70 | 18 | 333 | 7,34 |
| 36 H 200 | 2F | St | 36 | 145,53 | 144,16 | 152 | 80 | 58,7 | 70 | 18 | 334 | 7,75 |
| 38 H 200 | 2F | St | 38 | 153,62 | 152,24 | 158 | 80 | 58,7 | 70 | 18 | 335 | 8,62 |
| 40 H 200 | 2F | St | 40 | 161,70 | 160,33 | 168 | 80 | 58,7 | 70 | 18 | 338 | 9,50 |
| 44 H 200 | 4F | GG | 44 | 177,87 | 176,50 | 184 | 80 | 58,7 | 70 | 18 | 339 | 5,14 |
| 45 H 200 | 4F | GG | 45 | 181,91 | 180,54 | 192 | 80 | 58,7 | 70 | 18 | 340 | 5,38 |
| 48 H 200 | 4F | GG | 48 | 194,04 | 192,67 | 200 | 90 | 58,7 | 75 | 24 | 342 | 6,29 |
| 50 H 200 | 4 | GG | 50 | 202,13 | 200,75 | | 90 | 58,7 | 75 | 24 | | 6,68 |
| 52 H 200 | 4 | GG | 52 | 210,21 | 208,84 | | 90 | 58,7 | 75 | 24 | | 6,81 |
| 58 H 200 | 4 | GG | 58 | 234,47 | 233,09 | | 90 | 58,7 | 75 | 24 | | 7,26 |
| 60 H 200 | 4 | GG | 60 | 242,55 | 241,18 | | 100 | 58,7 | 75 | 24 | | 8,25 |
| 70 H 200 | 4 | GG | 70 | 282,98 | 281,61 | | 100 | 58,7 | 75 | 28 | | 9,20 |
| 72 H 200 | 4 | GG | 72 | 291,06 | 289,69 | | 120 | 58,7 | 75 | 28 | | 11,09 |
| 84 H 200 | 4 | GG | 84 | 339,57 | 338,20 | | 120 | 58,7 | 75 | 28 | | 12,63 |
| 96 H 200 | 4 | GG | 96 | 388,08 | 386,71 | | 120 | 58,7 | 75 | 28 | | 14,51 |
| 120 H 200 | 4 | GG | 120 | 485,10 | 483,73 | | 120 | 58,7 | 75 | 28 | | 19,15 |

H 300

PITCH 1/2" (12,7 mm)
FOR BELT WIDTH 3" (76,2 mm)

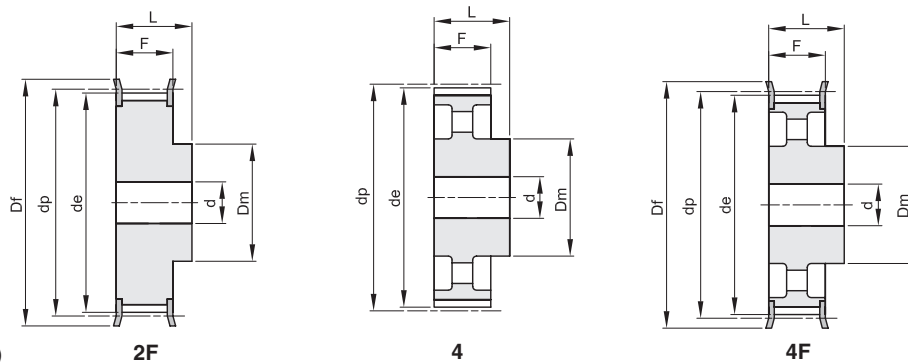

Материал Стомана (St) / Material Steel (St)

Материал Чугун (GG) / Material Cast Iron (GG)

| code | type | material | teeth | dp | de | Df | Dm | F | L | d | n° flange | Kg. |
|-----------|------|----------|-------|--------|--------|-----|-----|------|-----|----|-----------|-------|
| 14 H 300 | 2F | St | 14 | 56,59 | 55,22 | 63 | 40 | 85,7 | 100 | 18 | 309 | 1,64 |
| 15 H 300 | 2F | St | 15 | 60,64 | 59,27 | 66 | 45 | 85,7 | 100 | 18 | 310 | 1,91 |
| 16 H 300 | 2F | St | 16 | 64,68 | 63,31 | 71 | 45 | 85,7 | 100 | 18 | 311 | 2,16 |
| 17 H 300 | 2F | St | 17 | 68,72 | 67,35 | 75 | 45 | 85,7 | 100 | 18 | 312 | 2,43 |
| 18 H 300 | 2F | St | 18 | 72,77 | 71,39 | 79 | 55 | 85,7 | 100 | 18 | 313 | 2,80 |
| 19 H 300 | 2F | St | 19 | 76,81 | 75,44 | 83 | 60 | 85,7 | 100 | 18 | 314 | 3,16 |
| 20 H 300 | 2F | St | 20 | 80,85 | 79,48 | 87 | 62 | 85,7 | 100 | 18 | 315 | 3,50 |
| 21 H 300 | 2F | St | 21 | 84,89 | 83,52 | 91 | 65 | 85,7 | 100 | 18 | 316 | 3,87 |
| 22 H 300 | 2F | St | 22 | 88,94 | 87,56 | 93 | 68 | 85,7 | 100 | 18 | 317 | 4,26 |
| 23 H 300 | 2F | St | 23 | 92,98 | 91,61 | 97 | 72 | 85,7 | 100 | 18 | 318 | 4,68 |
| 24 H 300 | 2F | St | 24 | 97,03 | 95,65 | 103 | 72 | 85,7 | 100 | 18 | 320 | 5,08 |
| 25 H 300 | 2F | St | 25 | 101,06 | 99,69 | 106 | 72 | 85,7 | 100 | 18 | 321 | 5,45 |
| 26 H 300 | 2F | St | 26 | 105,11 | 103,73 | 111 | 80 | 85,7 | 100 | 18 | 322 | 6,01 |
| 27 H 300 | 2F | St | 27 | 109,15 | 107,78 | 115 | 80 | 85,7 | 100 | 18 | 323 | 6,45 |
| 28 H 300 | 2F | St | 28 | 113,19 | 111,82 | 119 | 80 | 85,7 | 100 | 18 | 325 | 6,91 |
| 30 H 300 | 2F | St | 30 | 121,29 | 119,90 | 127 | 80 | 85,7 | 100 | 18 | 327 | 7,90 |
| 32 H 300 | 2F | St | 32 | 129,36 | 127,99 | 135 | 80 | 85,7 | 100 | 18 | 328 | 8,92 |
| 33 H 300 | 2F | St | 33 | 133,40 | 132,03 | 140 | 80 | 85,7 | 100 | 18 | 330 | 9,46 |
| 34 H 300 | 2F | St | 34 | 137,45 | 136,07 | 143 | 80 | 85,7 | 100 | 18 | 331 | 10,04 |
| 35 H 300 | 2F | St | 35 | 141,49 | 140,12 | 148 | 80 | 85,7 | 100 | 18 | 333 | 10,62 |
| 36 H 300 | 2F | St | 36 | 145,53 | 144,16 | 152 | 80 | 85,7 | 100 | 18 | 334 | 11,24 |
| 38 H 300 | 2F | St | 38 | 153,62 | 152,24 | 158 | 80 | 85,7 | 100 | 18 | 335 | 12,44 |
| 40 H 300 | 2F | St | 40 | 161,70 | 160,33 | 168 | 80 | 85,7 | 100 | 18 | 338 | 13,80 |
| 44 H 300 | 4F | GG | 44 | 177,87 | 176,50 | 184 | 80 | 85,7 | 100 | 24 | 339 | 7,22 |
| 48 H 300 | 4F | GG | 48 | 194,04 | 192,67 | 200 | 90 | 85,7 | 100 | 24 | 342 | 8,60 |
| 50 H 300 | 4 | GG | 50 | 202,13 | 200,75 | | 90 | 85,7 | 100 | 24 | | 8,99 |
| 58 H 300 | 4 | GG | 58 | 234,47 | 233,09 | | 90 | 85,7 | 100 | 24 | | 10,04 |
| 60 H 300 | 4 | GG | 60 | 242,55 | 241,18 | | 100 | 85,7 | 100 | 24 | | 11,18 |
| 72 H 300 | 4 | GG | 72 | 291,06 | 289,69 | | 120 | 85,7 | 100 | 28 | | 15,07 |
| 84 H 300 | 4 | GG | 84 | 339,57 | 338,20 | | 120 | 85,7 | 100 | 28 | | 16,97 |
| 96 H 300 | 4 | GG | 96 | 388,08 | 386,71 | | 120 | 85,7 | 100 | 28 | | 19,86 |
| 120 H 300 | 4 | GG | 120 | 485,10 | 483,73 | | 120 | 85,7 | 100 | 28 | | 25,91 |

XH 200

PITCH 7/8" (22,22 mm)
FOR BELT WIDTH 2" (50,8 mm)

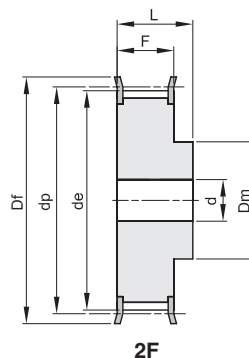

Материал Стомана (St) / Material Steel (St)

| code | type | material | teeth | dp | de | Df | Dm | F | L | d | n° flange | Kg. |
|-----------|------|----------|-------|--------|--------|-----|-----|----|----|----|-----------|-------|
| 18 XH 200 | 2F | St | 18 | 127,34 | 124,55 | 138 | 100 | 65 | 80 | 24 | 401 | 6,00 |
| 19 XH 200 | 2F | St | 19 | 134,41 | 131,62 | 146 | 100 | 65 | 80 | 24 | 402 | 6,60 |
| 20 XH 200 | 2F | St | 20 | 141,49 | 138,69 | 154 | 100 | 65 | 80 | 24 | 403 | 7,30 |
| 21 XH 200 | 2F | St | 21 | 148,56 | 145,77 | 160 | 110 | 65 | 80 | 24 | 404 | 8,73 |
| 22 XH 200 | 2F | St | 22 | 155,64 | 152,84 | 168 | 110 | 65 | 80 | 24 | 405 | 9,55 |
| 24 XH 200 | 2F | St | 24 | 169,79 | 166,99 | 183 | 120 | 65 | 80 | 24 | 406 | 11,47 |
| 25 XH 200 | 2F | St | 25 | 176,86 | 174,07 | 188 | 120 | 65 | 80 | 24 | 407 | 12,46 |
| 26 XH 200 | 2F | St | 26 | 183,93 | 181,14 | 198 | 120 | 65 | 80 | 24 | 409 | 13,47 |
| 27 XH 200 | 2F | St | 27 | 191,01 | 188,22 | 200 | 120 | 65 | 80 | 24 | 410 | 14,42 |
| 28 XH 200 | 2F | St | 28 | 198,09 | 195,29 | 211 | 120 | 65 | 80 | 24 | 411 | 15,44 |
| 30 XH 200 | 2F | St | 30 | 212,23 | 209,44 | 226 | 120 | 65 | 80 | 24 | 412 | 17,69 |
| 32 XH 200 | 2F | St | 32 | 226,38 | 223,59 | 240 | 120 | 65 | 80 | 24 | 414 | 19,95 |
| 34 XH 200 | 2F | St | 34 | 240,53 | 237,74 | 256 | 120 | 65 | 80 | 24 | 415 | 22,75 |

XH 300

PITCH 7/8" (22,22 mm)
FOR BELT WIDTH 3" (76,2 mm)

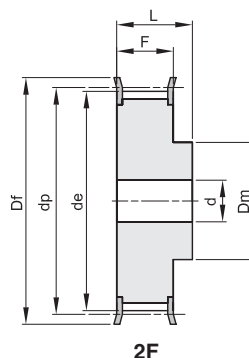

Материал Стомана (St) / Material Steel (St)

| code | type | material | teeth | dp | de | Df | Dm | F | L | d | n° flange | Kg. |
|-----------|------|----------|-------|--------|--------|-----|-----|----|-----|----|-----------|-------|
| 18 XH 300 | 2F | St | 18 | 127,34 | 124,55 | 138 | 100 | 92 | 110 | 28 | 401 | 8,90 |
| 19 XH 300 | 2F | St | 19 | 134,41 | 131,62 | 146 | 100 | 92 | 110 | 28 | 402 | 9,20 |
| 20 XH 300 | 2F | St | 20 | 141,49 | 138,69 | 154 | 100 | 92 | 110 | 28 | 403 | 10,61 |
| 21 XH 300 | 2F | St | 21 | 148,56 | 145,77 | 160 | 110 | 92 | 110 | 28 | 404 | 11,87 |
| 22 XH 300 | 2F | St | 22 | 155,64 | 152,84 | 168 | 110 | 92 | 110 | 28 | 405 | 13,08 |
| 24 XH 300 | 2F | St | 24 | 169,79 | 166,99 | 183 | 120 | 92 | 110 | 28 | 406 | 15,77 |
| 25 XH 300 | 2F | St | 25 | 176,86 | 174,07 | 188 | 120 | 92 | 110 | 28 | 407 | 17,13 |
| 26 XH 300 | 2F | St | 26 | 183,93 | 181,14 | 198 | 120 | 92 | 110 | 28 | 409 | 18,55 |
| 27 XH 300 | 2F | St | 27 | 191,01 | 188,22 | 200 | 120 | 92 | 110 | 28 | 410 | 19,90 |
| 28 XH 300 | 2F | St | 28 | 198,09 | 195,29 | 211 | 150 | 92 | 110 | 28 | 411 | 22,27 |
| 30 XH 300 | 2F | St | 30 | 212,23 | 209,44 | 226 | 150 | 92 | 110 | 28 | 412 | 25,39 |
| 32 XH 300 | 2F | St | 32 | 226,38 | 223,59 | 240 | 150 | 92 | 110 | 28 | 414 | 28,73 |
| 34 XH 300 | 2F | St | 34 | 240,53 | 237,74 | 256 | 150 | 92 | 110 | 28 | 415 | 34,20 |

XH 400

PITCH 7/8" (22,22 mm)

FOR BELT WIDTH 4" (101,6 mm)

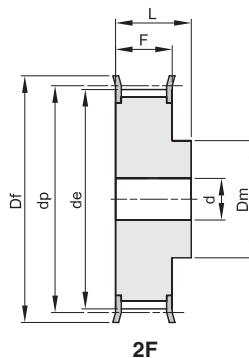

Материал Стомана (St) / Material Steel (St)

| code | type | material | teeth | dp | de | Df | Dm | F | L | d | n° flange | Kg. |
|-----------|------|----------|-------|--------|--------|-----|-----|-----|-----|----|-----------|-------|
| 18 XH 400 | 2F | St | 18 | 127,34 | 124,55 | 138 | 100 | 119 | 132 | 32 | 401 | 9,60 |
| 19 XH 400 | 2F | St | 19 | 134,41 | 131,62 | 146 | 100 | 119 | 132 | 32 | 402 | 10,80 |
| 20 XH 400 | 2F | St | 20 | 141,49 | 138,69 | 154 | 100 | 119 | 132 | 32 | 403 | 12,87 |
| 21 XH 400 | 2F | St | 21 | 148,56 | 145,77 | 160 | 110 | 119 | 132 | 32 | 404 | 14,42 |
| 22 XH 400 | 2F | St | 22 | 155,64 | 152,84 | 168 | 110 | 119 | 132 | 32 | 405 | 15,44 |
| 24 XH 400 | 2F | St | 24 | 169,79 | 166,99 | 183 | 120 | 119 | 132 | 32 | 406 | 19,22 |
| 25 XH 400 | 2F | St | 25 | 176,86 | 174,07 | 188 | 120 | 119 | 132 | 32 | 407 | 21,05 |
| 26 XH 400 | 2F | St | 26 | 183,93 | 181,14 | 198 | 120 | 119 | 132 | 32 | 409 | 22,80 |
| 27 XH 400 | 2F | St | 27 | 191,01 | 188,22 | 200 | 120 | 119 | 132 | 32 | 410 | 24,66 |
| 28 XH 400 | 2F | St | 28 | 198,09 | 195,29 | 211 | 150 | 119 | 132 | 32 | 411 | 27,23 |
| 30 XH 400 | 2F | St | 30 | 212,23 | 209,44 | 226 | 150 | 119 | 132 | 32 | 412 | 31,30 |
| 32 XH 400 | 2F | St | 32 | 226,38 | 223,59 | 240 | 150 | 119 | 132 | 32 | 414 | 35,20 |
| 34 XH 400 | 2F | St | 34 | 240,53 | 237,74 | 256 | 150 | 119 | 132 | 32 | 415 | 40,00 |

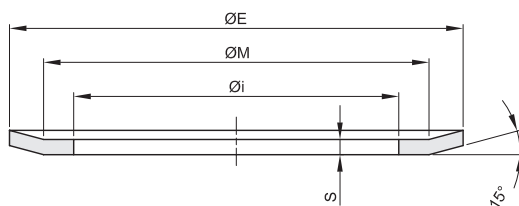

| thickness S=0.5mm | | | | thickness S=1.0mm | | | | thickness S=1.5mm | | | | thickness S=2.5mm | | | |
|-------------------|------|------|------|-------------------|------|-------|------|-------------------|-----|-------|-------|-------------------|-----|-------|-------|
| n° flange | Ø E | Ø M | Ø i | n° flange | Ø E | Ø M | Ø i | n° flange | Ø E | Ø M | Ø i | n° flange | Ø E | Ø M | Ø i |
| 100 | 13 | 10 | 6 | 200 | 19,5 | 17,5 | 12,5 | 300 | 36 | 31 | 25 | 400 | 127 | 120,2 | 104,7 |
| 101 | 15 | 12 | 8 | 201 | 23 | 17,5 | 12 | 301 | 38 | 34 | 28 | 401 | 138 | 130 | 108 |
| 102 | 16 | 13 | 9,5 | 202 | 23 | 20 | 14 | 302 | 42 | 38 | 30,5 | 402 | 146 | 138 | 116 |
| 104 | 18 | 15 | 11,5 | 203 | 25 | 22 | 15 | 303 | 44 | 40 | 33 | 403 | 154 | 146 | 122 |
| 105 | 19,5 | 17,5 | 12 | 204 | 28 | 24 | 18 | 304 | 48 | 43,5 | 37 | 404 | 160 | 150 | 128 |
| 106 | 23 | 17,5 | 12 | 205 | 32 | 28 | 21,5 | 305 | 51 | 47,5 | 40 | 405 | 168 | 162 | 135 |
| 107 | 23 | 20 | 14 | 206 | 36 | 31 | 25 | 306 | 54 | 50,5 | 43 | 406 | 183 | 170 | 145 |
| 108 | 25 | 22 | 15 | 207 | 38 | 34 | 28 | 307 | 57 | 53 | 46 | 407 | 188 | 180 | 158 |
| 109 | 28 | 24 | 18 | 208 | 42 | 38 | 30,5 | 308 | 60 | 57 | 47 | 409 | 198 | 188 | 165 |
| 110 | 32 | 28 | 21,5 | 209 | 44 | 40 | 33 | 309 | 63 | 57 | 48 | 410 | 200 | 192,8 | 172 |
| 111 | 36 | 31 | 25 | 210 | 48 | 43,5 | 37 | 310 | 66 | 61,5 | 52 | 411 | 211 | 198 | 173 |
| 112 | 38 | 34 | 28 | 211 | 51 | 47,5 | 40 | 311 | 71 | 65 | 56 | 412 | 226 | 214 | 190 |
| 113 | 42 | 38 | 30,5 | 212 | 54 | 50,5 | 43 | 312 | 75 | 68,5 | 60 | 414 | 240 | 224 | 192 |
| 114 | 48 | 43,5 | 37 | 213 | 57 | 53 | 46 | 313 | 79 | 73,5 | 64 | 415 | 256 | 240 | 220 |
| | | | | 214 | 60 | 57 | 47 | 314 | 83 | 76,5 | 68 | 416 | 256 | 247 | 225 |
| | | | | 215 | 63 | 57 | 48 | 315 | 87 | 82,5 | 72 | 418 | 296 | 287 | 252 |
| | | | | 216 | 66 | 61,5 | 52 | 316 | 91 | 85,5 | 76 | | | | |
| | | | | 217 | 71 | 65 | 56 | 317 | 93 | 89 | 80 | | | | |
| | | | | 218 | 75 | 68,5 | 60 | 318 | 97 | 93 | 83 | | | | |
| | | | | 219 | 83 | 76,5 | 68 | 319 | 98 | 92 | 79,3 | | | | |
| | | | | 220 | 87 | 82,5 | 72 | 320 | 103 | 97 | 86 | | | | |
| | | | | 221 | 91 | 85,5 | 76 | 321 | 106 | 101 | 90 | | | | |
| | | | | 222 | 93 | 89 | 80 | 322 | 111 | 106 | 94 | | | | |
| | | | | 223 | 97 | 93 | 83 | 323 | 115 | 110 | 99 | | | | |
| | | | | 224 | 106 | 101 | 90 | 325 | 119 | 113,5 | 103 | | | | |
| | | | | 225 | 119 | 113,5 | 103 | 326 | 123 | 117,5 | 107 | | | | |
| | | | | 226 | 131 | 125,5 | 115 | 327 | 127 | 122 | 111 | | | | |
| | | | | | | | | 328 | 135 | 130 | 119 | | | | |
| | | | | | | | | 330 | 140 | 134,5 | 123 | | | | |
| | | | | | | | | 331 | 143 | 139 | 127 | | | | |
| | | | | | | | | 333 | 148 | 143 | 132 | | | | |
| | | | | | | | | 334 | 152 | 147,5 | 136 | | | | |
| | | | | | | | | 335 | 158 | 154 | 142 | | | | |
| | | | | | | | | 338 | 168 | 163 | 149,5 | | | | |
| | | | | | | | | 339 | 184 | 179 | 165 | | | | |
| | | | | | | | | 340 | 192 | 187 | 173 | | | | |
| | | | | | | | | 342 | 200 | 195 | 181 | | | | |

| N°THEET PULLEY | MXL TH. 0,5 | XL TH. 1 | L TH. 1,5 | H TH. 1,5 | XH TH. 2,5 | HTD 3M TH. 0,5 | HTD 5M TH. 1 | HTD 8M TH. 1,5 | HTD 14M TH. 2,5 | T 2,5 TH. 0,5 | T 5 TH. 1 | T 10 TH. 1 | BAT 5 TH. 1 | BAT 10 TH. 1 |
|-------------------|----------------|-------------|--------------|--------------|---------------|-------------------|-----------------|-------------------|--------------------|------------------|--------------|---------------|----------------|-----------------|
| 10 | | 201 | 300 | | | 100 | | | | | 200 | 206 | | |
| 11 | | 201 | 301 | | | | | | | | 201 | 207 | | |
| 12 | 100 | 203 | 302 | | | 101 | 202 | | | 100 | 201 | 208 | 201 | 208 |
| 13 | | 203 | 303 | | | | 203 | | | 100 | 203 | 209 | 203 | |
| 14 | 100 | 204 | 304 | 309 | | 102 | 203 | | | 101 | 203 | 210 | 203 | 210 |
| 15 | 100 | 204 | 305 | 310 | | 104 | 204 | | | 101 | 204 | 211 | 204 | 211 |
| 16 | 101 | 205 | 306 | 311 | | 104 | 204 | | | 102 | 205 | 212 | 205 | 212 |
| 17 | | 205 | 307 | 312 | | | 205 | | | 104 | 205 | 213 | 205 | 213 |
| 18 | 102 | 206 | 308 | 313 | 401 | 105 | 205 | 304 | | 104 | 205 | 214 | 205 | 214 |
| 19 | | 206 | 309 | 314 | 402 | | 205 | 305 | | 104 | 206 | 216 | 206 | 216 |
| 20 | 102 | 207 | 310 | 315 | 403 | 107 | 206 | 306 | | 105 | 206 | 216 | 206 | 216 |
| 21 | | 207 | 311 | 316 | 404 | 108 | 207 | 307 | | 105 | 207 | 217 | 207 | 217 |
| 22 | 104 | 208 | 312 | 317 | 405 | 108 | 207 | 308 | | 106 | 207 | 218 | 207 | 218 |
| 23 | | 208 | 313 | 318 | | | 208 | 309 | | | 208 | 313 | 208 | 313 |
| 24 | 104 | 209 | 313 | 320 | 406 | 108 | 208 | 310 | | 107 | 208 | 219 | 208 | 219 |
| 25 | 105 | 210 | 314 | 321 | 407 | | 209 | 310 | | 107 | 209 | 219 | 209 | 219 |
| 26 | 106 | 210 | 315 | 322 | 409 | 109 | 209 | 311 | | 108 | 209 | 220 | 209 | 220 |
| 27 | | 210 | 315 | 323 | 410 | | 210 | | | | 210 | 221 | 210 | 221 |
| 28 | 107 | 211 | 316 | 325 | 411 | 110 | 210 | 312 | 400 | 108 | 210 | 222 | 210 | 222 |
| 29 | | 211 | | 326 | | | | | | 109 | 211 | | | |
| 30 | 107 | 212 | 318 | 327 | 412 | 110 | 211 | 314 | 401 | 109 | 211 | 223 | 211 | 223 |
| 32 | 108 | 213 | 320 | 328 | 414 | 111 | 212 | 315 | 403 | 110 | 212 | 224 | 212 | 224 |
| 33 | | 213 | 321 | 330 | | | | | | | | | | |
| 34 | 108 | 214 | 322 | 331 | 415 | | 213 | 316 | 404 | 110 | 213 | 323 | 213 | 323 |
| 35 | | 215 | 322 | 333 | | | | 317 | | 110 | 214 | | | |
| 36 | 109 | 216 | 323 | 334 | | 112 | 214 | 319 | 405 | 111 | 215 | 225 | 215 | 225 |
| 37 | | | | | | | | | | | 215 | | | |
| 38 | 109 | 217 | | 335 | | | 216 | 320 | 406 | 111 | 216 | 327 | 216 | 327 |
| 39 | | 217 | | | | | | | | | | | | |
| 40 | 110 | 217 | 327 | 338 | | 113 | 217 | 321 | 407 | 112 | 216 | 226 | 216 | 226 |
| 41 | | 218 | | | | | | | | | | | | |
| 42 | 110 | 218 | 328 | | | | 218 | | | | 217 | | 217 | 330 |
| 43 | | 313 | | | | | | | | | | | | |
| 44 | 111 | 313 | 330 | 339 | | 114 | 218 | 325 | 411 | 113 | 218 | | 218 | 331 |
| 45 | 111 | | 331 | 340 | | | 313 | | | 113 | 313 | 333 | | |
| 46 | | | | | | | | | | | 313 | | 313 | 334 |
| 48 | 111 | 220 | 334 | 342 | | | 219 | 327 | 412 | | 219 | 335 | 219 | 335 |
| 50 | 112 | | | | | | 220 | | | 209 | 220 | | | |
| 52 | | | | | | | | | | | | | 220 | 338 |
| 56 | | 223 | | | | | 222 | 333 | 416 | | | | 222 | 339 |
| 58 | | | | | | | | | | | | | 223 | 340 |
| 60 | 113 | 320 | | | | | 320 | | | 211 | 320 | 342 | 320 | 342 |
| 64 | | | | | | | 224 | 338 | 418 | | | | | 224 |
| 65 | | | | | | | | | | 213 | | | | |
| 70 | 211 | | | | | | | | | 215 | | | | |
| 72 | 211 | 326 | | | | | 225 | 340 | | 215 | 225 | | 225 | |
| 80 | | | | | | | | | | | 226 | | | |
| 90 | | | | | | | | | | 219 | 333 | | | |
| 100 | | | | | | | | | | 220 | 338 | | | |