

3/8" x 7/32"

9,525 x 5,72 mm
Roller 6,35 mm
06B - 1 - 2 - 3

B1	B2	B3	b1	C	r3
5,3	15,4	25,6	5,2	1	10

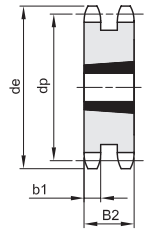
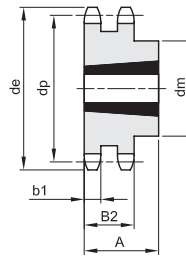
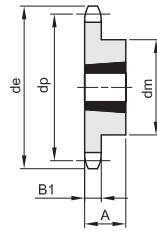
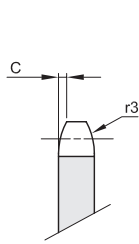

1

2

3

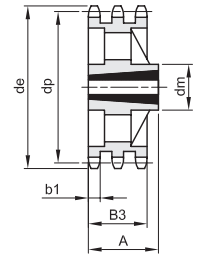
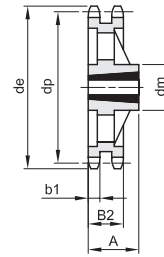
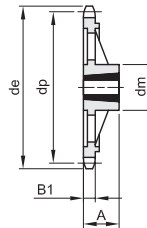
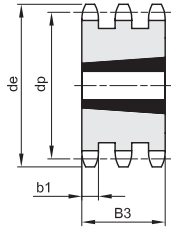
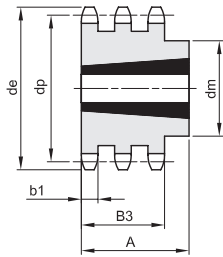

4

5

6

7

8

Материал C45 / Material C45

Z	de	dp	Единични / Simplex				Двойни / Duplex				Тройни / Triplex						
			dm	A Taper Bush Type		Kg.	dm	A Taper Bush Type		Kg.	dm	A Taper Bush Type		Kg.			
17	55,5	51,83	45	22	1008	1	0,11	41	22	1008	2	0,11	25,6	1008	5	0,15	
18	58,6	54,85	45	22	1008	1	0,14	43	22	1008	2	0,15					
19	61,6	57,86	45	22	1008	1	0,15	46	22	1008	2	0,18	25,6	1008	5	0,24	
20	64,6	60,89	46	22	1008	1	0,16	48	22	1008	2	0,22					
21	67,6	63,90	46	22	1008	1	0,18	49	22	1008	2	0,16	25,6	1008	5	0,34	
22	70,6	66,93	55	22	1108	1	0,25	52	22	1108	2	0,28					
23	73,7	69,95	63	25	1210	1	0,27	59	25	1210	2	0,27	25,6	1210	5	0,30	
24	76,7	72,97	63	25	1210	1	0,30	61	25	1210	2	0,32					
25	79,7	75,99	63	25	1210	1	0,32	64	25	1210	2	0,37	25,6	1210	5	0,41	
26	82,7	79,02	63	25	1210	1	0,33	65	25	1210	2	0,44					
27	85,7	82,04	63	25	1210	1	0,34	70	25	1210	2	0,50	25,6	1210	5	0,55	
28	88,8	85,07	63	25	1210	1	0,37	70	25	1210	2	0,57					
30	94,8	91,12	63	25	1210	1	0,39	75	25	1210	2	0,68	79	38	1615	4	0,88
38	119,0	115,34	70	25	1210	1	0,65	80	25	1610	2	1,03	90	38	1615	4	1,75
45	141,1	136,54	70	25	1210	1	1,01										
57*	177,5	172,91	83	25	1210	6	1,34	92	25	1610	7	1,16					
76*	235,1	230,49	83	25	1210	6	1,84	92	25	1610	7	2,19					

1/2" x 5/16"
12,7 x 7,75 mm
Roller 8,51 mm
08B - 1 - 2 - 3

B1	B2	B3	b1	C	r3
7,2	21	34,9	7	1,3	13

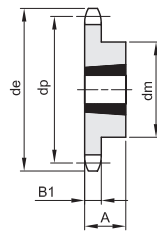
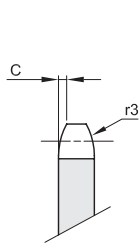

1

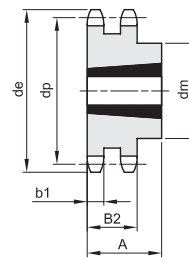

2

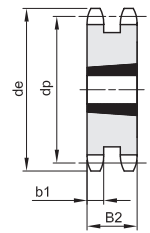

3

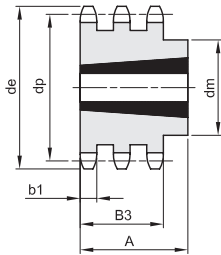

4

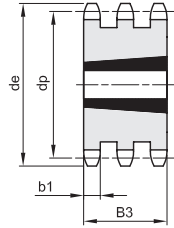

5

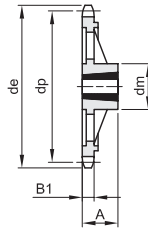

6

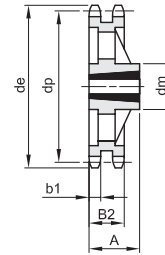

7

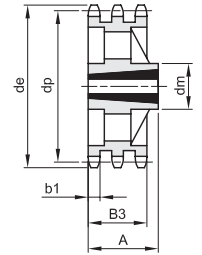

8

Материал C45 / Material C45

Z	de	dp	Единични / Simplex				Двойни / Duplex				Тройни / Triplex						
			dm	A	Taper Bush Type	Kg.	dm	A	Taper Bush Type	Kg.	dm	A	Taper Bush Type	Kg.			
15	66,5	61,80	45	22	1008	1	0,16	46	22	1008	2	0,22	34,9	1008	5	0,36	
16	69,9	65,10	50	22	1108	1	0,20	50	22	1108	2	0,22					
17	74,5	69,11	60	25	1210	1	0,22	56	25	1210	2	0,23	34,9	1210	5	0,35	
18	78,0	73,14	60	25	1210	1	0,27	60	25	1210	2	0,30					
19	82,5	77,15	63	25	1210	1	0,33	62	25	1210	2	0,38	62	38	1215	4	0,61
20	86,0	81,19	67	25	1610	1	0,27	66	25	1610	2	0,45					
21	90,6	85,21	71	25	1610	1	0,36	70	25	1610	2	0,50	70	38	1615	4	0,65
22	94,1	89,24	71	25	1610	1	0,36	76	25	1610	2	0,55					
23	98,7	93,26	76	25	1610	1	0,50	79	25	1610	2	0,62	70	38	1615	4	0,93
24	102,1	97,29	76	25	1610	1	0,53	84	32	2012	2	0,68					
25	106,7	101,32	76	25	1610	1	0,56	87	32	2012	2	0,72	34,9	2012	5	0,85	
26	110,2	105,36	76	25	1610	1	0,60	87	32	2012	2	0,82					
27	114,8	109,39	76	25	1610	1	0,63	87	32	2012	2	0,92	34,9	2012	5	1,18	
28	118,3	113,42	90	32	2012	1	0,77	87	32	2012	2	1,10					
30	126,9	121,49	90	32	2012	1	0,91	87	32	2012	2	1,24	34,9	2012	5	1,73	
38	159,2	153,79	90	32	2012	1	1,25	100	32	2012	2	2,50	34,9	2012	5	3,53	
45	188,6	182,07	111	32	2012	1	1,68										
57*	237,1	230,54	111	32	2012	6	2,78	111	32	2012	7	3,64					
76*	313,9	307,33	111	32	2012	6	3,81	111	32	2012	7	5,09					

5/8" x 3/8"

15,875 x 9,65 mm
Roller 10,16 mm
10B - 1 - 2 - 3

B1	B2	B3	b1	C	r3
----	----	----	----	---	----

9,1	25,5	42,1	9	1,6	16
-----	------	------	---	-----	----

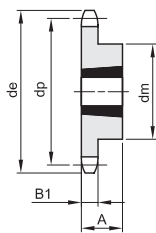
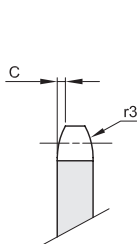

1

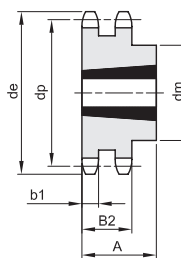

2

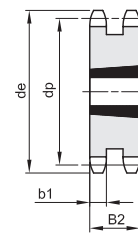

3

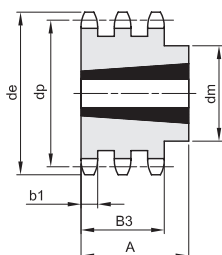

4

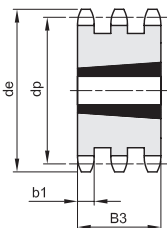

5

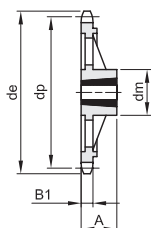

6

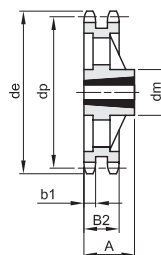

7

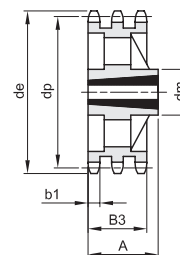

8

Материал C45 / Material C45

Z	de	dp	Единични / Simplex				Двойни / Duplex				Тройни / Triplex						
			dm	A	Taper Bush Type	Kg.	dm	A	Taper Bush Type	Kg.	dm	A	Taper Bush Type	Kg.			
13	73,2	66,33	47	22	1008	1	0,23										
14	78,2	71,34	52	22	1108	1	0,27										
15	83,2	76,35	60	25	1210	1	0,30	25,5	1210	3	0,38	42,1	1215	5	0,63		
16	88,3	81,37	63	25	1210	1	0,38	25,5	1610	3	0,42						
17	93,3	86,39	71	25	1610	1	0,38	25,5	1610	3	0,47	42,1	1215	5	1,01		
18	98,3	91,42	71	25	1610	1	0,43	25,5	1610	3	0,60						
19	103,3	96,44	75	25	1610	1	0,54	25,5	1610	3	0,72	42,1	1615	5	1,19		
20	108,4	101,49	76	25	1610	1	0,61	25,5	1610	3	0,87						
21	113,4	106,51	76	25	1610	1	0,65	25,5	1610	3	1,01	42,1	1615	5	1,66		
22	118,4	111,55	76	25	1610	1	0,72	25,5	1610	3	1,18						
23	123,5	116,58	76	25	1610	1	0,77	25,5	1610	3	1,35	42,1	2012	5	1,78		
24	128,5	121,62	90	32	2012	1	0,98	90	32	2012	2	1,45					
25	133,6	126,66	90	32	2012	1	1,05	90	32	2012	2	1,55	105	44	2517	4	1,81
26	138,6	131,70	90	32	2012	1	1,11	90	32	2012	2	1,75					
27	143,6	136,74	90	32	2012	1	1,17	90	32	2012	2	1,98	110	44	2517	4	2,45
28	148,7	141,78	90	32	2012	1	1,29	90	32	2012	2	2,30					
30	158,8	151,87	90	32	2012	1	1,40	90	32	2012	2	2,63	120	44	2517	4	3,54
38	199,1	192,23	100	32	2012	1	2,43										
45	236,0	227,58	111	32	2012	1	3,55										
57*	296,6	288,18	111	32	2012	6	4,28										
76*	392,5	384,16	111	32	2012	6	5,95										

3/4" x 7/16"

19,05 x 11,68 mm

Roller 12,07 mm

12B - 1 - 2 - 3

B1	B2	B3	b1	C	r3
----	----	----	----	---	----

11,1	30,3	49,8	10,8	2	19
------	------	------	------	---	----

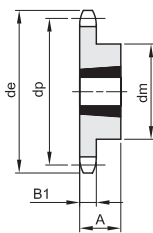
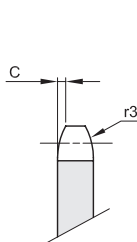

1

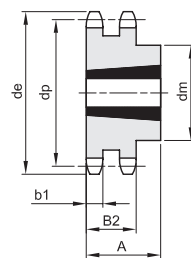

2

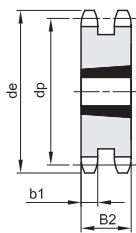

3

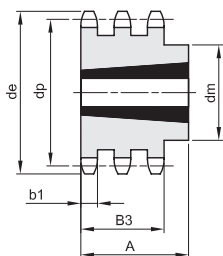

4

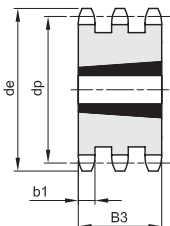

5

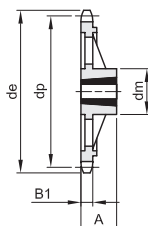

6

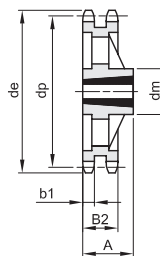

7

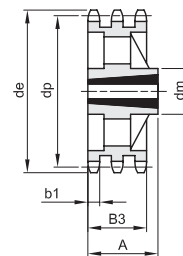

8

Материал С45 / Material C45

Z	de	dp	Единични / Simplex				Двойни / Duplex				Тройни / Triplex						
			dm	A	Taper Bush Type	Kg.	dm	A	Taper Bush Type	Kg.	dm	A	Taper Bush Type	Kg.			
13	87,8	79,60	60	25	1210	1	0,35										
14	93,8	85,61	67	25	1610	1	0,40										
15	99,8	91,62	70	25	1610	1	0,44		30,3	1610	3	0,68		49,8	1615	5	1,11
16	105,8	97,65	71	25	1610	1	0,53		30,3	1610	3	0,89					
17	111,9	103,67	76	25	1610	1	0,66		30,3	1610	3	1,14		49,8	1615	5	1,75
18	117,9	109,71	90	32	2012	1	0,86	90	32	2012	2	1,18					
19	123,9	115,73	90	32	2012	1	0,94	90	32	2012	2	1,24		49,8	2012	5	1,99
20	130,0	121,78	90	32	2012	1	1,04	108	44	2517	2	1,40					
21	136,0	127,81	102	44	2517	1	1,24	108	44	2517	2	1,68		49,8	2517	5	2,09
22	142,0	133,86	108	44	2517	1	1,60	108	44	2517	2	1,99					
23	148,1	139,90	108	44	2517	1	1,70	108	44	2517	2	2,24		49,8	2517	5	3,00
24	154,1	145,94	108	44	2517	1	1,81	108	44	2517	2	2,54					
25	160,2	151,99	108	44	2517	1	1,93	108	44	2517	2	2,87		49,8	2517	5	3,98
26	166,2	158,04	108	44	2517	1	2,04	108	44	2517	2	3,17					
27	172,3	164,09	108	44	2517	1	2,14	108	44	2517	2	3,55	140	51	3020	4	3,90
28	178,3	170,13	108	44	2517	1	2,37	108	44	2517	2	4,10					
30	190,4	182,24	108	44	2517	1	2,60	108	44	2517	2	4,62	140	51	3020	4	5,64
38	238,9	230,69	108	44	2517	1	3,93	140	51	3020	2	8,11	140	51	3020	4	11,58
45	283,2	273,10	124	44	2517	1	5,52										
57*	355,9	345,81	124	44	2517	6	6,48	160	51	3020	7	10,28	160	51	3020	8	13,23
76*	471,1	460,99	124	44	2517	6	9,71	160	51	3020	7	15,24					

1"1/4 x 3/4"

31,75 x 19,56 mm
Roller 19,05 mm
20B - 1 - 2 - 3

B1	B2	B3	b1	C	r3
----	----	----	----	---	----

18,5	54,6	91	18,2	3,5	32
------	------	----	------	-----	----

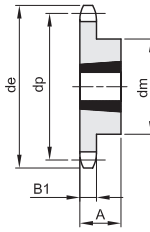
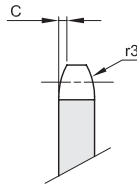

1

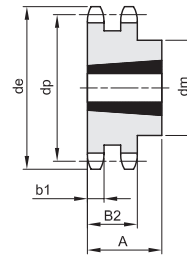

2

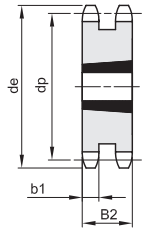

3

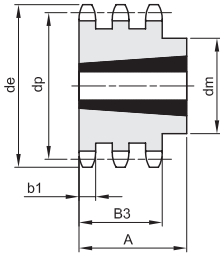

4

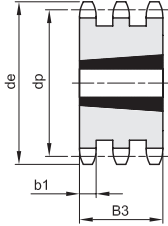

5

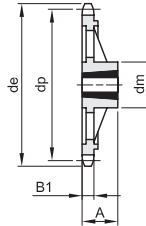

6

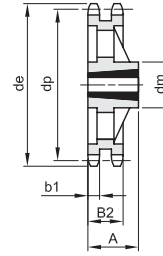

7

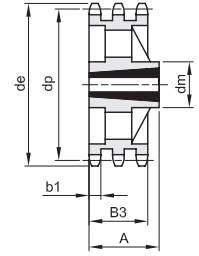

8

Материал С45 / Material C45

Z	de	dp	dm	Единични / Simplex				Двойни / Duplex				Тройни / Triplex						
				A	Taper Bush	Type	Kg.	dm	A	Taper Bush	Type	Kg.	dm	A	Taper Bush	Type	Kg.	
12	137,0	122,68	90	32	1615	1	1,90											
13	147,5	132,65	90	32	2012	1	1,50	54,6	2517	3	2,20							
14	157,6	142,68	110	44	2517	1	2,40											
15	167,7	152,72	110	44	2517	1	3,39	54,6	2517	3	4,00	91	3020	5	4,43			
16	177,7	162,75	110	44	2517	1	4,23											
17	187,7	172,78	110	44	2517	1	5,07	54,6	2517	3	5,00	91	3030	5	7,39			
18	197,8	182,85	110	44	2517	1	5,91											
19	207,9	192,91	110	44	2517	1	6,75	140	76	3030	2	6,30	91	3030	5	11,65		
20	217,9	202,98	110	44	2517	1	7,23											
21	228,0	213,04	120	44	2517	1	7,70	140	76	3030	2	8,80	91	3535	5	12,80		
23	248,2	233,17	120	44	2517	1	8,78	140	76	3030	2	9,80	91	3535	5	17,38		
25	268,4	253,33	120	44	2517	1	9,50	140	76	3030	2	10,50	91	3535	5	22,40		
30	318,7	303,75	160	51	3020	1	11,90	160	76	3030	2	14,00	91	3535	5	36,50		
38*	399,4	384,49	160	51	3020	6	15,80	160	76	3030	7	22,00	178	91	3535	8	28,00	
57*	592,3	576,36	160	51	3020	6	25,50	175	89	3535	7	37,00	216	102	4040	8	42,00	
76*	784,3	768,32	160	51	3020	6	39,00	175	89	3535	7	62,00	260	114	4545	8	85,00	

1"1/2 x 1"

38,1 x 25,4 mm
Roller 25,4 mm
24B - 1 - 2 - 3

B1	B2	B3	b1	C	r3
----	----	----	----	---	----

24,1	72	120,3	23,6	4	38
------	----	-------	------	---	----

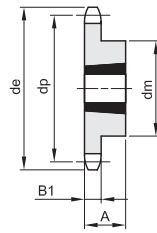
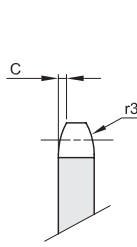

1

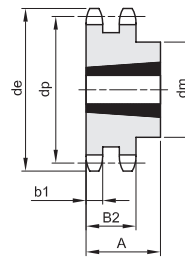

2

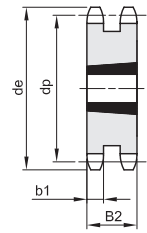

3

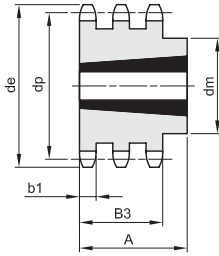

4

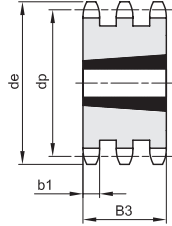

5

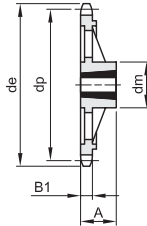

6

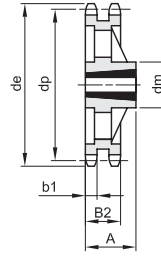

7

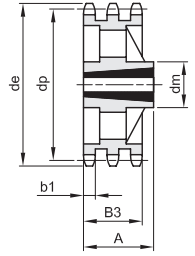

8

Материал С45 / Material C45

Z	de	dp	dm	Единични / Simplex				Двойни / Duplex				Тройни / Triplex							
				A	Taper Bush	Type	Kg.	dm	A	Taper Bush	Type	Kg.	A	Taper Bush	Type	Kg.			
11	149,0	135,21	90	32	2012	1	1,70												
12	161,0	147,22	90	32	2012	1	2,20												
13	173,0	159,18	110	44	2517	1	2,80		72	2517	3	5,30							
14	185,0	171,22	120	44	2517	1	3,60												
15	197,0	183,26	120	44	2517	1	4,40		72	3020	3	6,60		120,3	3030	5	20,00		
17	221,0	207,34	140	51	3020	1	6,35		72	3020	3	10,30		120,3	3030	5	25,00		
18	233,0	219,42	140	51	3020	1	6,60												
19	245,5	231,49	140	51	3020	1	6,60	160	76	3030	2	14,80		120,3	3535	5	30,00		
20	257,5	243,57	140	51	3020	1	7,50												
21	270,5	255,65	140	51	3020	1	8,40	160	76	3030	2	19,50		120,3	4040	5	35,00		
23	294,5	279,80	160	51	3020	1	11,30	175	89	3535	2	24,00		120,3	4040	5	44,00		
25	319,0	304,00	160	51	3020	1	12,80	175	89	3535	2	29,00		120,3	4040	5	50,00		
30	379,5	364,50	160	51	3020	1		175	89	3535	2	40,00		120,3	4040	5	60,00		
38*	476,5	461,39	160	76	3030	6	24,00	175	89	3535	7	44,00		120,3	4040	8	66,00		
57*	707,5	691,63	160	76	3030	6	45,00	175	89	3535	7	72,00		120,3	4545	8	120,00		
76*	939,0	921,98	175	89	3535	6	70,00	216	102	4040	7	107,00		120,3	4545	8	131,00		